

AVAILABLE IN BOTH

IMPORT

DOMESTIC

CARBON STEEL

PIPE FLANGES (ANSI)
A105 / A105N



JABO SUPPLY



5 LOCATIONS

PARKERSBURG, WV

10085 Emerson Avenue 26102
(304) 464-4400

MORGANFIELD, KY

118 Jim Veatch Road, 42437
(270) 389-3430

HUNTINGTON WV

209 Braley Street, 25705
(304) 736-8333

NORTON, VA

205 Hawthorne Drive, 24273
(276) 679-1224

BEAVER, WV (BECKLEY)

227 C&O Shop Road 25813
(304-252-0000

SINCE 1964 SERVICE IS MORE THAN A PROMISE

INDEX

	PAGE #
Picture Index Import Flanges	4-5
Picture Index Domestic Domestic Flanges	6-7
Types of Flanges	8
Difference between A105 & A105N (Normalized)	9
Commonly Asked Questions	10
Difference between Raised Face & Flat Face Flange	11
How to Order a Flange	11
How to Measure a Flange	12
Pressure Rating Chart	13
Specifications/ Dimensions / Bolt Patterns	40-48

IMPORT CARBON STEEL FLANGES

SPECIFICATION	TYPES	CLASS RATING		
		150	300	600
A105	Weld Neck Raised Face STD Bore	15	21	
	Weld Neck Flat Face STD Bore	15		
	Weld Neck Raised Face XH Bore	15	21	25
	Slip On Raised Face	16	22	25
	Slip On Flat Face	16		
	Threaded Raised Face	17	22	
	Threaded Flat Face	17		
	Threaded Reducing Flat Face	17		
	Blind Raised Face	18	23	25
	Blind Flat Face	18		
	Lap (Rotating) Raised Face	19	23	
	Lap (Rotating) Flat Face			
	Socket Weld Raised Face	19	23	
A105N	Slip On Raised Face	27		



IMPORT CARBON STEEL FLANGES

SPECIFICATION	TYPES	CLASS RATING		
		150	300	600
A105	Weld Neck Raised Face STD Bore	29	35	39
	Weld Neck Flat Face STD Bore	29		
	Weld Neck Raised Face XH Bore	29	35	39
	Slip On Raised Face	30	36	39
	Slip On Flat Face	30		
	Threaded Raised Face	31	36	
	Threaded Flat Face	31		
	Threaded Reducing Flat Face	31		
	Blind Raised Face	32	37	38
	Blind Flat Face	32		
	Lap (Rotating) Raised Face	33	37	
	Lap (Rotating) Flat Face	33		
	Socket Weld Raised Face	33	37	



PICTURE INDEX IMPORT ANSI A105 CLASS 150 / 300 FLANGES

150 WELD NECK RAISED FACE STD BORE	150 WELD NECK FLAT FACE STD BORE	150 WELD NECK RAISED FACE XH BORE	150 SLIP ON RAISED FACE
			
PAGE 15	PAGE 15	PAGE 15	PAGE 16
150 SLIP ON FLAT FACE	150 THREADED RAISED FACE	150 THREADED FLAT FACE	150 THREADED REDUCING FLAT FACE
		NO PICTURE AVAILABLE	
PAGE 16	PAGE 17	PAGE 17	PAGE 17
150 BLIND RAISED FACE	150 BLIND FLAT FACE	150 LAP (ROTATING) RAISED FACE	150 SOCKET WELD RAISED FACE
			
PAGE 18	PAGE 18	PAGE 19	PAGE 19
300 WELD NECK RAISED FACE STD BORE	300 WELD NECK FLAT FACE STD BORE	300 WELD NECK RAISED FACE XH BORE	300 SLIP ON RAISED FACE
	NO PICTURE AVAILABLE		
PAGE 21	NON STOCK NOT IN CATALOG	PAGE 21	PAGE 22
300 SLIP ON FLAT FACE	300 THREADED RAISED FACE	300 THREADED FLAT FACE	300 THREADED REDUCING FLAT FACE
NO PICTURE AVAILABLE		NO PICTURE AVAILABLE	NO PICTURE AVAILABLE
NON STOCK NOT IN CATALOG	PAGE 22	NON STOCK NOT IN CATALOG	NON STOCK NOT IN CATALOG
300 BLIND RAISED FACE	300 BLIND FLAT FACE	300 LAP (ROTATING) RAISED FACE	300 SOCKET WELD RAISED FACE
	NO PICTURE AVAILABLE		
PAGE 23	NON STOCK NOT IN CATALOG	PAGE 23	PAGE 23

PICTURE INDEX IMPORT ANSI A105 CLASS 600 FLANGES

600 WELD NECK	600 WELD NECK	600 WELD NECK	600 SLIP ON
RAISED FACE STD BORE	FLAT FACE STD BORE	RAISED FACE XH BORE	RAISED FACE
	NO PICTURE AVAILABLE	NO PICTURE AVAILABLE	
PAGE 25	NON STOCK NOT IN CATALOG	NON STOCK NOT IN CATALOG	PAGE 25
SLIP ON	600 THREADED	600 THREADED	600 THREADED REDUCING
FLAT FACE	RAISED FACE	FLAT FACE	FLAT FACE
NO PICTURE AVAILABLE	NO PICTURE AVAILABLE	NO PICTURE AVAILABLE	NO PICTURE AVAILABLE
NON STOCK NOT IN CATALOG	NON STOCK NOT IN CATALOG	NON STOCK NOT IN CATALOG	NON STOCK NOT IN CATALOG
600 BLIND	600 BLIND	600 LAP (ROTATING)	600 SOCKET WELD
RAISED FACE	FLAT FACE	RAISED FACE	RAISED FACE
	NO PICTURE AVAILABLE	NO PICTURE AVAILABLE	NO PICTURE AVAILABLE
PAGE 25	NON STOCK NOT IN CATALOG	NON STOCK NOT IN CATALOG	NON STOCK NOT IN CATALOG

PICTURE INDEX IMPORT ANSI 105N CLASS 150





150 NORMALIZED SLIP ON
RAISED FACE

PAGE 27

PICTURE INDEX DOMESTIC ANSI A105 CLASS 150 / 300 FLANGES

150 WELD NECK	150 WELD NECK	150 WELD NECK	150 SLIP ON
RAISED FACE STD BORE	FLAT FACE STD BORE	RAISED FACE XH BORE	RAISED FACE
			
PAGE 29	PAGE 29	PAGE 29	PAGE 30
150 SLIP ON	150 THREADED	150 THREADED	150 THREADED REDUCING
FLAT FACE	RAISED FACE	FLAT FACE	FLAT FACE
		NO PICTURE AVAILABLE	
PAGE 30	PAGE 31	PAGE 31	PAGE 31
150 BLIND	150 BLIND	150 LAP (ROTATING)	150 SOCKET WELD
RAISED FACE	FLAT FACE	RAISED FACE	RAISED FACE
			
PAGE 32	PAGE 32	PAGE 33	PAGE 33
300 WELD NECK	300 WELD NECK	300 WELD NECK	300 SLIP ON
RAISED FACE STD BORE	FLAT FACE STD BORE	RAISED FACE XH BORE	RAISED FACE
	NO PIC AVAILABLE		
PAGE 35	NON STOCK NOT IN CATALOG	PAGE 34	PAGE 36
300 SLIP ON	300 THREADED	300 THREADED	300 THREADED REDUCING
FLAT FACE	RAISED FACE	FLAT FACE	FLAT FACE
NO PICTURE AVAILABLE		NO PICTURE AVAILABLE	NO PICTURE AVAILABLE
NON STOCK NOT IN CATALOG	PAGE 36	NON STOCK NOT IN CATALOG	NON STOCK NOT IN CATALOG
300 BLIND	300 BLIND	300 LAP (ROTATING)	300 SOCKET WELD
RAISED FACE	FLAT FACE	RAISED FACE	RAISED FACE
	NO PICTURE AVAILABLE		
PAGE 37	NON STOCK NOT IN CATALOG	PAGE 37	PAGE 37

PICTURE INDEX DOMESTIC ANSI A105 CLASS 600 FLANGES







600 WELD NECK	600 WELD NECK	600 WELD NECK	600 SLIP ON
RAISED FACE STD BORE	FLAT FACE STD BORE	RAISED FACE XH BORE	RAISED FACE
			
PAGE 39	NON STOCK NOT IN CATALOG	PAGE 39	PAGE 39
SLIP ON	600 THREADED	600 THREADED	600 THREADED REDUCING
FLAT FACE	RAISED FACE	FLAT FACE	FLAT FACE
		NO PICTURE AVAILABLE	
NON STOCK NOT IN CATALOG	NON STOCK NOT IN CATALOG	NON STOCK NOT IN CATALOG	NON STOCK NOT IN CATALOG
600 BLIND	600 BLIND	600 LAP (ROTATING)	600 SOCKET WELD
RAISED FACE	FLAT FACE	RAISED FACE	RAISED FACE
	NO PICTURE AVAILABLE	NO PICTURE AVAILABLE	NON STOCK NOT IN CATALOG
PAGE 39	NON STOCK NOT IN CATALOG	NON STOCK NOT IN CATALOG	NON STOCK NOT IN CATALOG



PICTURE INDEX IMPORT ANSI 105N CLASS 150

150 NORMALIZED SLIP ON
RAISED FACE

NON STOCK NOT IN CATALOG

TYPES OF FLANGES

WELD NECK	SLIP ON	THREADED FLANGE
		
Named for their protruding necks, these bulky flanges share the environmental stress of the pipe to which they are affixed and can, therefore, be used in extreme temperature or pressure situations.	Slip-on flanges slip onto the pipe – and are then welded on both the inside and outside. They're inexpensive, popular and best used in low-pressure, low-temperature applications.	Threaded pipe flanges are similar in design to slip-ons but has a tapered thread, meaning it can be attached to pipes without welding. Like Slip-on flanges, they're best used in low-pressure, low-temperature environment.
BLIND	LAP/ROTATING	SOCKET WELD
		
Blind flanges don't have a bore and are used to shut off sections of pipe. They're suitable for high-pressure applications, as well as for testing the flow of gas or liquid through a pipe.	Lap Joint Flanges are intended to saddle over a stub end fitting. They feature an extended hub and a machined radius at the base of the flat face.	Typically used on small, high-pressure pipes like hydraulic pipes, socket weld flanges are able to accept pipe into the socket to create the fitting.

AVAIL IN IMPORT	AVAIL IN DOMESTIC	AVAIL IN THE FOLLOWING	
		CALL JABO SUPPLY	SPECS 1. A105/A105N
CALL YOUR JABO CSR FOR MORE DETAILS			TYPE OF FACE 1. Raised/Flat
			CLASS 150-1500
			*JABO stocking 150/300 Class with limited larger sizes

DIFFERENCE BETWEEN A105 AND A105N

Composition

ASTM A105 and A105N are both carbon steel materials but are compositionally different. ASTM A105 is a forging specification that covers a carbon steel alloy used for high-temperature service. It contains low carbon, manganese, phosphorus, and sulfur content. ASTM A105N, on the other hand, is also a forging specification but requires a minimum of 0.35% silicon. This is added to improve its mechanical properties, mainly its strength and toughness. So, while ASTM A105 is a generic carbon steel, A105N is a modified carbon steel with additional silicon content.

Heat Treatment

Heat treatment of materials is crucial in determining their physical and mechanical properties. ASTM A105, a basic carbon steel, has a maximum carbon content of 0.35%. This means heat treatment is unnecessary for this material, except for stress-relieving purposes. Heat treatment may be required if the carbon content exceeds 0.35%. A105N, on the other hand, is a modified carbon steel with additional silicon content, which imparts better mechanical properties. This material requires heat

Usage

ASTM A105 and A105N are commonly used in high-pressure applications, such as steam and gas piping systems. ASTM A105 is generally used in low-pressure systems, whereas A105N is used in high-pressure systems. This is due to its higher silicon content, which provides better strength and toughness, making it ideal for higher-pressure applications. In addition, A105N is not recommended for low-temperature applications, while A105 can be used for a wider temperature range.

Tensile Strength

The tensile strength of ASTM A105 is greater than that of ASTM A105N. The yield strength of ASTM A105 is also greater than that of ASTM A105N.

Impact Strength

The impact strength of ASTM A105 is lower than that of ASTM A105N. This means that ASTM A105 is more likely to break under impact than ASTM A105N.

Temperature Range

The temperature range of ASTM A105 is -20 to 400 degrees Fahrenheit (-29 to 204 degrees Celsius). The temperature range of ASTM A105N is -20 to 500 degrees Fahrenheit (-29 to 260 degrees Celsius). This means that ASTM A105N can be used at higher temperatures than ASTM A105.

Cost

Cost is one of the major factors when choosing a material for your projects. As a plain carbon steel, ASTM A105 is generally cheaper than A105N, which requires additional elements such as silicon, manganese, and nickel to improve its mechanical properties. The extra cost of A105N comes with enhanced strength and toughness, making it suitable for demanding applications.

MOST COMMONLY ASKED QUESTIONS

HOW ARE FLANGES DESCRIBED?

While working with ASME/ANSI Flange, the terms such as Flange Ratings, Flange Pressure Ratings, Flange Class, and pressure-temperature rating of flanges are quite confusing. Below is a breakdown of each terminology used in the industry.

DIFFERENT TERMINOLOGY FOR FLANGES

The industry refers to flanges in many different ways. Below are a few common ways to refer to a 150 Class Flange.

Class #150

150-pound flange

Class 150 Flange Pressure Rating

150 lb flange

ALL ARE THE SAME 150 CLASS FLANGE

PLEASE LET YOUR CSR KNOW
WHEN ORDERING IF AN MTR IS
REQUIRED.

PRESSURE RATING AND OR CLASS

Flanges are broken out into 6 different classes or pound classes

150#	900#
300#	1500#
600#	2500#

***This is not the pressure rating of the flange but the pounds per sq inch**

Pressure rating is defined as **the maximum allowed pressure that a flange can withstand at increasing temperatures**. According to the ANSI/ASME B16.5 specification, there are seven flange pressure ratings: 150, 300, 600, 900, 1500, and 2500

The higher the flange ratings, the heavier the flange and can withstand higher pressure and temperature. So, when the temperature goes up for a given material, the maximum allowable pressure goes down, and vice versa. See below for a comparison of 6" Class 150 and Class 2500 weld neck flange.

EXAMPLE OF DIFFERENT SIZES

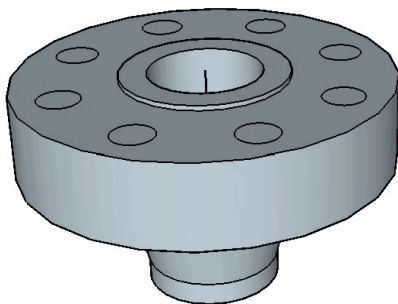

6" Class 2500 Weld Neck Flange

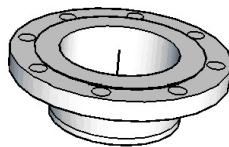

6" Class 150 Weld Neck Flange

DIFFERENCE BETWEEN RAISED FACE/FLAT FACE

RAISED FACE/FLAT FACE

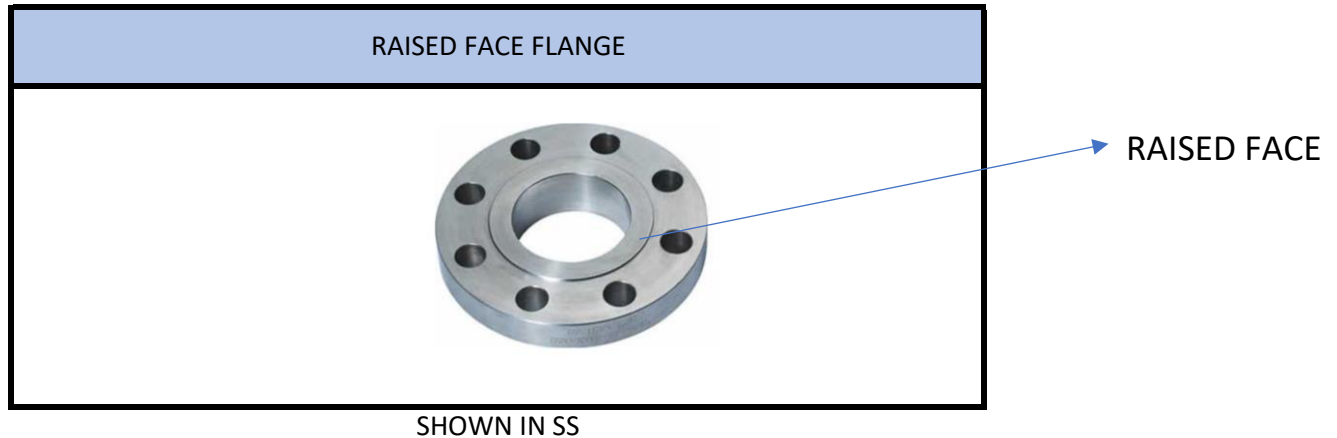

It is called raised face because the gasket is raised 1/16" to 1/4" above the bolt circle face. This face type allows the use of a wide combination of gasket designs, including flat ring sheet types and metallic composites such as spiral wound and double jacketed types.

The **purpose** of a RF flange is to concentrate more pressure on a smaller gasket area and thereby increase the pressure containment capability of the joint.

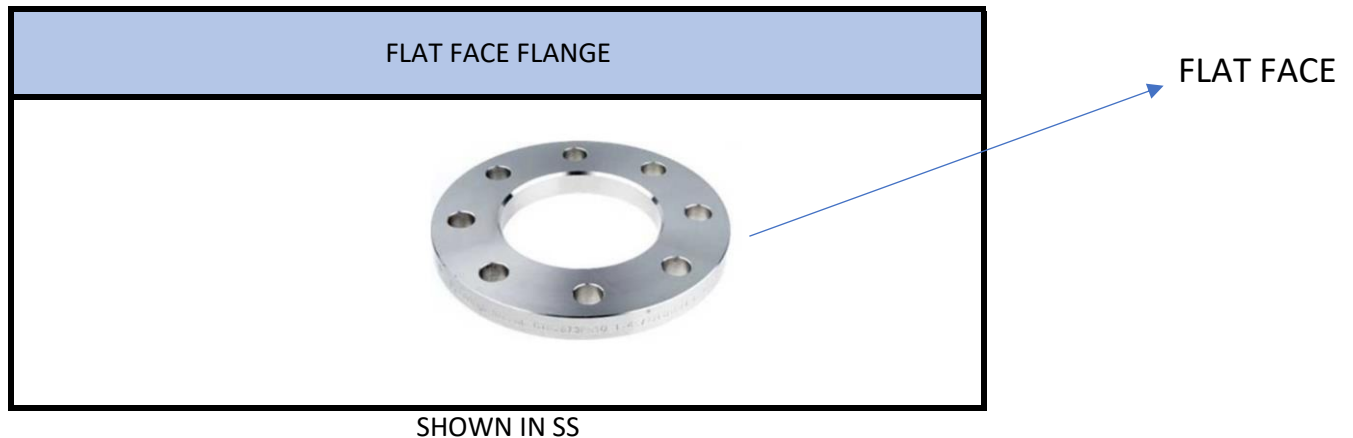

The flat face (full face) flange has a gasket surface in the same plane as the bolting circle face.

Applications using flat face flanges are frequently those in which the mating flange or flanged fitting is made from a casting.

HOW TO ORDER A FLANGE

HOW TO ORDER A FLANGE				
1. PROVIDE PART NUMBER TO YOUR JABO CSR				
2. PROVIDE THE BELOW INFORMATION TO YOUR CSR				
CHOOSE ONE FROM EACH COLUMN				
WHERE MFR	TYPE	SIZE	TYPE FACE	RATING
CHOOSE ONE	CHOOSE ONE	CHOOSE SIZE	CHOOSE ONE	CHOOSE ONE
	*WELD NECK	1/2"-48"		150#
	SLIP ON			300#
	**THREADED			600#
	BLIND			900#
1. IMPORT	LAP/ROTATING		1. RAISED FACE	1500#
2. DOMESTIC	SOCKET WELD		2. FLAT FACE	2500#
*When ordering Weld Neck Flanges Please provide bore size (AKA) neck such as sch 40, 80xh etc				
**Threaded Flange can be either size on size or a reducing threaded flange				

HOW TO MEASURE A FLANGE

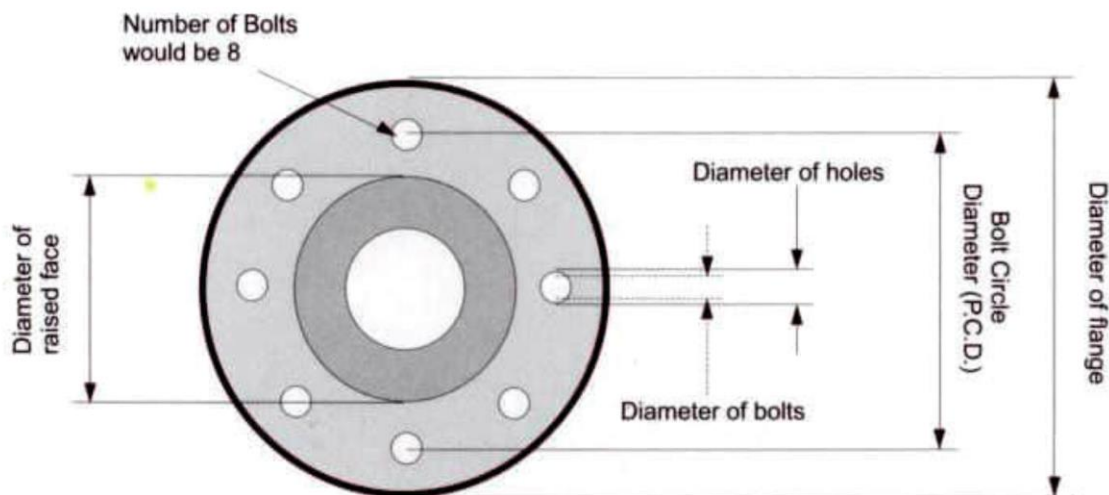

MOST COMMON PLACES TO MEASURE - See Flange Dimensions to Determine Size

PRESSURE RATING CHART

Flanges pressure rating in psig for common carbon steel ASME flanges (A105 / A350 LF2 / A350 LF3 / A350 LF6)							
Temperature (F°)	150#	300#	400#	600#	900#	1500#	2500#
-20 to 100	285	740	985	1480	2220	3705	6170
200	260	680	905	1360	2035	3395	5655
300	230	655	870	1310	1965	3270	5450
400	200	635	845	1265	1900	3170	5280
500	170	605	805	1205	1810	3015	5025
600	140	570	755	1135	1705	2840	4730
650	125	550	730	1100	1650	2745	4575
700	110	530	710	1060	1590	2655	4425
750	95	505	675	1015	1520	2535	4230
800	80	410	550	825	1235	2055	3430
850	65	320	425	640	955	1595	2655
900	50	230	305	460	690	1150	1915
950	35	135	185	275	410	685	1145
1000	20	85	115	170	255	430	715

The above table shows that in a 150 lb carbon steel flange, the allowable pressure is 285 psi at 100°F, 170 psi at 500°F, and 20 psi at 1000°F. The only temperature at which the flange is rated for 150 psi is near 500°F. Higher class flanges are rated at their nominal pressure rating only at near 850°F. See the cells in yellows.

IMPORT A105

CARBON STEEL FLANGES

CLASS 150
A105



IMPORT CLASS 150 A105

WELD NECK

RAISED FACE
STD BORE

IMPORT



JABO PART#	SIZE
107-00580	1/2"
107-00590	3/4"
107-00600	1"
107-00610	1-1/4"
107-00620	1-1/2"
107-00630	2"
107-00640	2-1/2"
107-00650	3"
*	3-1/2"
107-00670	4"
107-00680	5"
107-00690	6"
107-00700	8"
107-00710	10"
107-00720	12"
107-00730	14"
107-00740	16"
107-00750	18"
107-00760	20"
107-00770	24"
*NON STOCK CALL JABO SUPPLY	
OTHER SIZES AVAIL UPON REQUEST	
MTR AVAILABLE	

FLAT FACE
STD BORE

IMPORT



JABO PART#	SIZE
*	1/2"
*	3/4"
*	1"
*	1-1/4"
*	1-1/2"
107-01300	2"
107-01310	2-1/2"
107-01320	3"
*	3-1/2"
107-01340	4"
*	5"
107-01360	6"
107-01370	8"
*	10"
*	12"
*	14"
*	16"
*	18"
*	20"
*	24"
*NON STOCK CALL JABO SUPPLY	
OTHER SIZES AVAIL UPON REQUEST	
MTR AVAILABLE	

RAISED FACE
XH BORE

IMPORT



JABO PART#	SIZE
*	1/2"
*	3/4"
107-00100	1"
*	1-1/4"
107-00140	1-1/2"
107-00160	2"
*	2-1/2"
107-00180	3"
*	3-1/2"
107-00190	4"
*	5"
*	6"
*	8"
*	10"
*	12"
*	14"
*	16"
*	18"
*	20"
*	24"
*NON STOCK CALL JABO SUPPLY	
OTHER SIZES AVAIL UPON REQUEST	
MTR AVAILABLE	



IMPORT CLASS 150 A105

SLIP ON

SLIP ON
RAISED FACE

IMPORT



JABO PART#	SIZE
107-02590	1/2"
107-02600	3/4"
107-02610	1"
107-02620	1-1/4"
107-02630	1-1/2"
107-02640	2"
107-02650	2-1/2"
107-02660	3"
*	3-1/2"
107-02680	4"
107-02690	5"
107-02700	6"
107-02710	8"
107-02720	10"
107-02730	12"
107-02740	14"
107-02750	16"
107-02760	18"
107-02770	20"
107-02790	24"
*NON STOCK CALL JABO SUPPLY	
OTHER SIZES AVAIL UPON REQUEST	
MTR AVAILABLE	

SLIP ON
FLAT FACE

IMPORT



JABO PART#	SIZE
*	1/2"
*	3/4"
*	1"
*	1-1/4"
*	1-1/2"
107-02910	2"
107-02920	2-1/2"
107-02930	3"
*	3-1/2"
107-02950	4"
107-02960	5"
107-02970	6"
107-02980	8"
107-03000	10"
107-03020	12"
*	14"
*	16"
*	18"
*	20"
*	24"
*NON STOCK CALL JABO SUPPLY	
OTHER SIZES AVAIL UPON REQUEST	
MTR AVAILABLE	



IMPORT CLASS 150 A105

THREADED / REDUCING

THREADED
RAISED FACE

IMPORT



JABO PART#	SIZE
107-05590	1/2"
107-05600	3/4"
107-05610	1"
107-05620	1-1/4"
107-05630	1-1/2"
107-05640	2"
107-05650	2-1/2"
107-05660	3"
*	3-1/2"
107-05680	4"
107-05690	5"
107-05700	6"
107-05710	8"
*NON STOCK CALL JABO SUPPLY	
OTHER SIZES AVAIL UPON REQUEST	
MTR AVAILABLE	

THREADED
FLAT FACE

IMPORT

PIC NOT AVAIL

JABO PART#	SIZE
*	1/2"
*	3/4"
*	1"
*	1-1/4"
*	1-1/2"
*	2"
*	2-1/2"
*	3"
*	3-1/2"
*	4"
*	5"
*	6"
*	8"
*NON STOCK CALL JABO SUPPLY	
OTHER SIZES AVAIL UPON REQUEST	
MTR AVAILABLE	

THREADED REDUCING
FLAT FACE

IMPORT



JABO PART#	SIZE
107-05880	2" X 3/4"
107-05900	3" X 3/4"
107-05980	2" X 1"
107-06000	3" X 1"
107-06260	3" X 2"
107-06280	4" X 2"
*NON STOCK CALL JABO SUPPLY	
OTHER SIZES AVAIL UPON REQUEST	
MTR AVAIL ASK WHEN ORDERING	
JABO SUPPLY CAN FABRICATE ANY SIZE NEEDED BY USING A BLIND FLANGE	

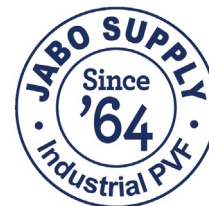

IMPORT CLASS 150 A105

BLIND FLANGE

BLIND
RAISED

IMPORT



JABO PART#	SIZE
107-08290	1/2"
107-08300	3/4"
107-08310	1"
107-08320	1-1/4"
107-08330	1-1/2"
107-08340	2"
107-08350	2-1/2"
107-08360	3"
*	3-1/2"
107-08380	4"
107-08390	5"
107-08400	6"
107-08410	8"
107-08420	10"
107-08430	12"
107-08440	14"
107-08450	16"
107-08460	18"
107-08480	20"
107-08500	24"
*NON STOCK CALL JABO SUPPLY	
OTHER SIZES AVAIL UPON REQUEST	
MTR AVAILABLE	

BLIND
FLAT FACE

IMPORT



JABO PART#	SIZE
*	1/2"
*	3/4"
*	1"
*	1-1/4"
*	1-1/2"
*	2"
*	2-1/2"
*	3"
*	3-1/2"
*	4"
*	5"
*	6"
*	8"
*	10"
*	12"
*	14"
*	16"
*	18"
*	20"
*	24"
*NON STOCK CALL JABO SUPPLY	
OTHER SIZES AVAIL UPON REQUEST	
MTR AVAILABLE	



IMPORT CLASS 150 A105

LAP (ROTATING) / SOCKET WELD

LAP (ROTATING)
RAISED FACE

IMPORT	
	
JABO PART#	SIZE
107-09270	1/2"
107-09280	3/4"
107-09290	1"
*	1-1/4"
107-09310	1-1/2"
107-09320	2"
107-09330	2-1/2"
107-09340	3"
*	3-1/2"
107-09360	4"
107-09370	5"
107-09380	6"
107-09390	8"
107-09400	10"
107-09410	12"
107-09420	14"
107-09430	16"
107-09440	18"
*	20"
*	24"
*NON STOCK CALL JABO SUPPLY	
OTHER SIZES AVAIL UPON REQUEST	
MTR AVAILABLE	

SOCKET WELD
RAISED FACE

IMPORT	
	
JABO PART#	SIZE
*	1/2"
107-09530	3/4"
107-09540	1"
*	1-1/4"
107-09560	1-1/2"
107-09570	2"
107-09580	2-1/2"
107-09590	3"
*	3-1/2"
107-09610	4"
*	5"
107-09630	6"
*	8"
*	10"
*	12"
*	14"
*	16"
*	18"
*	20"
*	24"
*NON STOCK CALL JABO SUPPLY	
OTHER SIZES AVAIL UPON REQUEST	
MTR AVAILABLE	



IMPORT A105

CARBON STEEL FLANGES

CLASS 300
A105



IMPORT CLASS 300 A105

WELD NECK

**WELD NECK
RAISED FACE
STD BORE**

IMPORT	
	
JABO PART#	SIZE
*	1/2"
*	3/4"
*	1"
*	1-1/4"
*	1-1/2"
107-09800	2"
107-10120	2-1/2"
107-10130	3"
*	3-1/2"
107-10150	4"
107-10160	5"
107-10170	6"
107-10180	8"
107-10190	10"
107-10200	12"
*	14"
*	16"
*	18"
107-10280	20"
*	24"
*NON STOCK CALL JABO SUPPLY	
OTHER SIZES AVAIL UPON REQUEST	
MTR AVAILABLE	

**WELD NECK
RAISED FACE
XH BORE**

IMPORT	
	
JABO PART#	SIZE
107-10060	1/2"
107-10070	3/4"
107-10080	1"
*	1-1/4"
107-10100	1-1/2"
107-10110	2"
*	2-1/2"
*	3"
*	3-1/2"
*	4"
*	5"
*	6"
*	8"
*	10"
*	12"
*	14"
*	16"
*	18"
107-10281	20"
107-10282	24"
*NON STOCK CALL JABO SUPPLY	
OTHER SIZES AVAIL UPON REQUEST	
MTR AVAILABLE	



IMPORT CLASS 300 A105N

SLIP ON / THREADED

SLIP ON
RAISED FACE

IMPORT



JABO PART#	SIZE
107-12070	1/2"
107-12080	3/4"
107-12090	1"
107-12100	1-1/4"
107-12110	1-1/2"
107-12120	2"
107-12130	2-1/2"
107-12140	3"
*	3-1/2"
107-12160	4"
107-12170	5"
107-12180	6"
107-12190	8"
107-12200	10"
107-12210	12"
107-12220	14"
107-12240	16"
107-12260	18"
*	20"
107-12300	24"
*NON STOCK CALL JABO SUPPLY	
OTHER SIZES AVAIL UPON REQUEST	
MTR AVAILABLE	

THREADED
RAISED FACE

IMPORT



JABO PART#	SIZE
107-14230	1/2"
107-14240	3/4"
107-14250	1"
107-14260	1-1/4"
107-14270	1-1/2"
107-14280	2"
107-14290	2-1/2"
107-14300	3"
*	3-1/2"
*	4"
*	5"
*	6"
*	8"
*NON STOCK CALL JABO SUPPLY	
OTHER SIZES AVAIL UPON REQUEST	
MTR AVAILABLE	



IMPORT CLASS 300 A105

BLIND/LAP (ROTATING) /SOCKET WELD

BLIND
RAISED FACE

IMPORT



JABO PART#	SIZE
107-16240	1/2"
107-16250	3/4"
107-16260	1"
*	1-1/4"
107-16280	1-1/2"
107-16290	2"
107-16300	2-1/2"
107-16310	3"
*	3-1/2"
107-16330	4"
*	5"
107-16350	6"
107-16360	8"
107-16370	10"
107-16390	12"
*	14"
*	16"
*	18"
107-16460	20"
107-16480	24"
*NON STOCK CALL JABO SUPPLY	
OTHER SIZES AVAIL UPON REQUEST	
MTR AVAILABLE	

LAP (ROTATING)
RAISED FACE

IMPORT



JABO PART#	SIZE
*	1/2"
*	3/4"
107-14400	1"
*	1-1/4"
107-14430	1-1/2"
107-14440	2"
*	2-1/2"
107-14470	3"
*	3-1/2"
107-14490	4"
*	5"
107-14500	6"
107-14520	8"
*	10"
*	12"
*	14"
*	16"
*	18"
*	20"
*	24"
*NON STOCK CALL JABO SUPPLY	
OTHER SIZES AVAIL UPON REQUEST	
MTR AVAILABLE	

SOCKET WELD
RAISED FACE

IMPORT



JABO PART#	SIZE
107-14800	1/2"
107-14820	3/4"
107-14840	1"
*	1-1/4"
107-14860	1-1/2"
107-14880	2"
107-14890	2-1/2"
107-14900	3"
*	3-1/2"
107-14920	4"
*	5"
107-15060	6"
*	8"
*	10"
*	12"
*	14"
*	16"
*	18"
*	20"
*	24"
*NON STOCK CALL JABO SUPPLY	
OTHER SIZES AVAIL UPON REQUEST	
MTR AVAILABLE	



IMPORT A105

CARBON STEEL FLANGES

CLASS 600

A105



IMPORT CLASS 600 A105

WELD NECK/ SLIP ON/ BLIND

WELD NECK
RAISED XH BORE

IMPORT	
	
JABO PART#	SIZE
107-20030	1/2"
107-20040	3/4"
107-20050	1"
*	1-1/4"
107-20070	1-1/2"
107-20080	2"
*	2-1/2"
107-20100	3"
*	3-1/2"
107-20120	4"
*	5"
*	6"
*	8"
*	10"
*	12"
*	14"
*	16"
*	18"
*	20"
*	24"
*NON STOCK CALL JABO SUPPLY	
OTHER SIZES AVAIL UPON REQUEST	
MTR AVAILABLE	

SLIP ON
RAISED FACE

IMPORT	
	
JABO PART#	SIZE
107-21400	1/2"
107-21410	3/4"
107-21420	1"
*	1-1/4"
107-21440	1-1/2"
107-21450	2"
*	2-1/2"
107-21470	3"
*	3-1/2"
107-21490	4"
*	5"
107-21500	6"
*	8"
*	10"
*	12"
*	14"
*	16"
*	18"
*	20"
*	24"
*NON STOCK CALL JABO SUPPLY	
OTHER SIZES AVAIL UPON REQUEST	
MTR AVAILABLE	

BLIND
RAISED FACE

IMPORT	
	
JABO PART#	SIZE
107-22450	1/2"
107-22460	3/4"
107-22470	1"
*	1-1/4"
107-22490	1-1/2"
107-22500	2"
*	2-1/2"
107-22520	3"
*	3-1/2"
107-22540	4"
*	5"
*	6"
*	8"
*	10"
*	12"
*	14"
*	16"
*	18"
*	20"
*	24"
*NON STOCK CALL JABO SUPPLY	
OTHER SIZES AVAIL UPON REQUEST	
MTR AVAILABLE	



IMPORT A105N

CARBON STEEL FLANGES

CLASS 150
NORMALIZED A105N



IMPORT NORMALIZED FLANGES A105N

SLIP ON
RAISED FACE

A105N

IMPORT



NORMALIZED FLANGES ARE
MANUFACTURED IN ALL FLANGE
TYPES AND CLASSES

JABO PART#	SIZE
*	1/2"
*	3/4"
107-30000	1"
*	1-1/4"
107-30001	1-1/2"
107-30002	2"
*	2-1/2"
107-30004	3"
*	3-1/2"
107-30006	4"
107-30008	5"
107-30010	6"
107-30012	8"
*	10"
*	12"
*	14"
*	16"
*	18"
*	20"
*	24"
*NON STOCK CALL JABO SUPPLY	
OTHER SIZES AVAIL UPON REQUEST	
MTR AVAILABLE	

DOMESTIC A105

CARBON STEEL FLANGES

CLASS 150
A105



DOMESTIC CLASS 150 A105**WELD NECK****WELD NECK
RAISED FACE
STD BORE****DOMESTIC**

JABO PART#	SIZE
*	1/2"
*	3/4"
*	1"
*	1-1/4"
007-00620	1-1/2"
007-00630	2"
*	2-1/2"
007-00650	3"
*	3-1/2"
007-00670	4"
007-00680	5"
007-00690	6"
007-00700	8"
007-00710	10"
007-00720	12"
*	14"
*	16"
*	18"
*	20"
*	24"
*NON STOCK CALL JABO SUPPLY	
OTHER SIZES AVAIL UPON REQUEST	
MTR AVAILABLE	

**WELD NECK
FLAT FACE
STD BORE****DOMESTIC**

JABO PART#	SIZE
*	1/2"
*	3/4"
*	1"
*	1-1/4"
*	1-1/2"
*	2"
*	2-1/2"
*	3"
*	3-1/2"
*	4"
*	5"
*	6"
*	8"
*	10"
*	12"
*	14"
*	16"
*	18"
*	20"
*	24"
*NON STOCK CALL JABO SUPPLY	
OTHER SIZES AVAIL UPON REQUEST	
MTR AVAILABLE	

**WELD NECK
RAISED FACE
XH BORE****DOMESTIC**

JABO PART#	SIZE
*	1/2"
*	3/4"
007-00100	1"
*	1-1/4"
007-00140	1-1/2"
007-00160	2"
*	2-1/2"
007-00180	3"
*	3-1/2"
007-00190	4"
*	5"
*	6"
*	8"
*	10"
*	12"
*	14"
*	16"
*	18"
*	20"
*	24"
*NON STOCK CALL JABO SUPPLY	
OTHER SIZES AVAIL UPON REQUEST	
MTR AVAILABLE	



DOMESTIC CLASS 150 A105**SLIP ON****SLIP ON
RAISED FACE****DOMESTIC**

JABO PART#	SIZE
*	1/2"
*	3/4"
*	1"
*	1-1/4"
007-02630	1-1/2"
007-02640	2"
007-02650	2-1/2"
007-02660	3"
*	3-1/2"
007-02680	4"
	5"
007-02700	6"
007-02710	8"
007-02720	10"
007-02730	12"
*	14"
*	16"
*	18"
*	20"
*	24"
*NON STOCK CALL JABO SUPPLY	
OTHER SIZES AVAIL UPON REQUEST	
MTR AVAILABLE	

**SLIP ON
FLAT FACE****DOMESTIC**

JABO PART#	SIZE
*	1/2"
*	3/4"
*	1"
*	1-1/4"
*	1-1/2"
*	2"
*	2-1/2"
*	3"
*	3-1/2"
*	4"
*	5"
*	6"
*	8"
*	10"
*	12"
*	14"
*	16"
*	18"
*	20"
*	24"
*NON STOCK CALL JABO SUPPLY	
OTHER SIZES AVAIL UPON REQUEST	
MTR AVAILABLE	



DOMESTIC CLASS 150 A105**THREADED / REDUCING****THREADED
RAISED FACE****DOMESTIC**

JABO PART#	SIZE
*	1/2"
*	3/4"
*	1"
*	1-1/4"
*	1-1/2"
007-05640	2"
*	2-1/2"
*	3"
*	3-1/2"
*	4"
*	5"
*	6"
*	8"
*NON STOCK CALL JABO SUPPLY	
OTHER SIZES AVAIL UPON REQUEST	
MTR AVAILABLE	

**THREADED
FLAT FACE****DOMESTIC**

PIC NOT AVAIL

JABO PART#	SIZE
*	1/2"
*	3/4"
*	1"
*	1-1/4"
*	1-1/2"
*	2"
*	2-1/2"
*	3"
*	3-1/2"
*	4"
*	5"
*	6"
*	8"
*NON STOCK CALL JABO SUPPLY	
OTHER SIZES AVAIL UPON REQUEST	
MTR AVAILABLE	

**THREADED REDUCING
RAISED FACE****DOMESTIC**

JABO PART#	SIZE
*	2" X 3/4"
*	3" X 3/4"
*	2" X 1"
*	3" X 1"
*	3" X 2"
*	4" X 2"
*NON STOCK CALL JABO SUPPLY	
OTHER SIZES AVAIL UPON REQUEST	
MTR AVAIL ASK WHEN ORDERING	
JABO SUPPLY CAN FABRICATE ANY SIZE NEEDED BY USING A BLIND FLANGE	



DOMESTIC CLASS 150 A105

BLIND FLANGE

BLIND
RAISED

DOMESTIC



JABO PART#	SIZE
*	1/2"
*	3/4"
*	1"
*	1-1/4"
007-08330	1-1/2"
007-08340	2"
007-08350	2-1/2"
007-08360	3"
*	3-1/2"
*	4"
*	5"
*	6"
*	8"
*	10"
*	12"
*	14"
*	16"
*	18"
*	20"
*	24"
*NON STOCK CALL JABO SUPPLY	
OTHER SIZES AVAIL UPON REQUEST	
MTR AVAILABLE	

BLIND
FLAT FACE

DOMESTIC



JABO PART#	SIZE
*	1/2"
*	3/4"
*	1"
*	1-1/4"
*	1-1/2"
*	2"
*	2-1/2"
*	3"
*	3-1/2"
*	4"
*	5"
*	6"
*	8"
*	10"
*	12"
*	14"
*	16"
*	18"
*	20"
*	24"
*NON STOCK CALL JABO SUPPLY	
OTHER SIZES AVAIL UPON REQUEST	
MTR AVAILABLE	



DOMESTIC CLASS 150 A105**LAP (ROTATING) / SOCKET WELD****LAP (ROTATING)
RAISED FACE****DOMESTIC**

JABO PART#	SIZE
*	1/2"
*	3/4"
*	1"
*	1-1/4"
*	1-1/2"
*	2"
*	2-1/2"
*	3"
*	3-1/2"
*	4"
*	5"
*	6"
*	8"
*	10"
*	12"
*	14"
*	16"
*	18"
*	20"
*	24"
*NON STOCK CALL JABO SUPPLY	
OTHER SIZES AVAIL UPON REQUEST	
MTR AVAILABLE	

**SOCKET WELD
RAISED FACE****DOMESTIC**

JABO PART#	SIZE
*	1/2"
*	3/4"
*	1"
*	1-1/4"
007-09560	1-1/2"
007-09570	2"
*	2-1/2"
*	3"
*	3-1/2"
*	4"
*	5"
*	6"
*	8"
*	10"
*	12"
*	14"
*	16"
*	18"
*	20"
*	24"
*NON STOCK CALL JABO SUPPLY	
OTHER SIZES AVAIL UPON REQUEST	
MTR AVAILABLE	



DOMESTIC A105

CARBON STEEL FLANGES

CLASS 300

A105



DOMESTIC CLASS 300 A105

WELD NECK

**WELD NECK
RAISED FACE
STD BORE**

DOMESTIC



JABO PART#	SIZE
*	1/2"
*	3/4"
*	1"
*	1-1/4"
*	1-1/2"
*	2"
*	2-1/2"
*	3"
*	3-1/2"
*	4"
*	5"
007-10170	6"
007-10180	8"
007-10190	10"
007-10200	12"
*	14"
*	16"
*	18"
*	20"
*	24"

*NON STOCK CALL JABO SUPPLY

OTHER SIZES AVAIL UPON REQUEST

MTR AVAILABLE

**WELD NECK
RAISED FACE
XH BORE**

DOMESTIC



JABO PART#	SIZE
*	1/2"
*	3/4"
*	1"
*	1-1/4"
*	1-1/2"
007-10110	2"
*	2-1/2"
*	3"
*	3-1/2"
*	4"
*	5"
*	6"
*	8"
*	10"
*	12"
*	14"
*	16"
*	18"
*	20"
*	24"

*NON STOCK CALL JABO SUPPLY

OTHER SIZES AVAIL UPON REQUEST

MTR AVAILABLE



DOMESTIC CLASS 300 A105

SLIP ON / THREADED

SLIP ON
RAISED FACE

DOMESTIC



JABO PART#	SIZE
007-12070	1/2"
*	3/4"
*	1"
*	1-1/4"
*	1-1/2"
007-12120	2"
007-12130	2-1/2"
007-12140	3"
*	3-1/2"
007-12160	4"
007-12170	5"
007-12180	6"
007-12190	8"
*	10"
*	12"
*	14"
*	16"
*	18"
*	20"
*	24"
*NON STOCK CALL JABO SUPPLY	
OTHER SIZES AVAIL UPON REQUEST	
MTR AVAILABLE	

THREADED
RAISED FACE

DOMESTIC



JABO PART#	SIZE
*	1/2"
*	3/4"
*	1"
*	1-1/4"
*	1-1/2"
007-14280	2"
*	2-1/2"
*	3"
*	3-1/2"
*	4"
*	5"
*	6"
*	8"
*NON STOCK CALL JABO SUPPLY	
OTHER SIZES AVAIL UPON REQUEST	
MTR AVAILABLE	



DOMESTIC CLASS 300 A105**BLIND / LAP (ROTATING) / SOCKET WELD****BLIND
RAISED FACE****DOMESTIC**

JABO PART#	SIZE
*	1/2"
*	3/4"
*	1"
*	1-1/4"
*	1-1/2"
*	2"
*	2-1/2"
*	3"
*	3-1/2"
*	4"
*	5"
007-16350	6"
*	8"
*	10"
*	12"
*	14"
*	16"
*	18"
*	20"
*	24"
*NON STOCK CALL JABO SUPPLY	
OTHER SIZES AVAIL UPON REQUEST	
MTR AVAILABLE	

**LAP (ROTATING)
RAISED FACE****DOMESTIC**

JABO PART#	SIZE
*	1/2"
*	3/4"
*	1"
*	1-1/4"
*	1-1/2"
*	2"
*	2-1/2"
*	3"
*	3-1/2"
*	4"
*	5"
*	6"
*	8"
*	10"
*	12"
*	14"
*	16"
*	18"
*	20"
*	24"
*NON STOCK CALL JABO SUPPLY	
OTHER SIZES AVAIL UPON REQUEST	
MTR AVAILABLE	

**SOCKET WELD
RAISED FACE****DOMESTIC**

JABO PART#	SIZE
*	1/2"
*	3/4"
*	1"
*	1-1/4"
*	1-1/2"
*	2"
*	2-1/2"
*	3"
*	3-1/2"
*	4"
*	5"
*	6"
*	8"
*	10"
*	12"
*	14"
*	16"
*	18"
*	20"
*	24"
*NON STOCK CALL JABO SUPPLY	
OTHER SIZES AVAIL UPON REQUEST	
MTR AVAILABLE	



DOMESTIC A105

CARBON STEEL FLANGES

CLASS 600

A105



DOMESTIC CLASS 600 A105**WELD NECK / SLIP ON / BLIND****WELD NECK
RAISED XH BORE****DOMESTIC**

JABO PART#	SIZE
*	1/2"
*	3/4"
007-20050	1"
*	1-1/4"
007-20070	1-1/2"
007-20080	2"
*	2-1/2"
*	3"
*	3-1/2"
*	4"
*	5"
*	6"
*	8"
*	10"
*	12"
*	14"
*	16"
*	18"
*	20"
*	24"

*NON STOCK CALL JABO SUPPLY

OTHER SIZES AVAIL UPON REQUEST

MTR AVAILABLE

**SLIP ON
RAISED FACE****DOMESTIC**

JABO PART#	SIZE
007-21400	1/2"
007-21410	3/4"
007-21420	1"
*	1-1/4"
007-21440	1-1/2"
007-21450	2"
*	2-1/2"
007-21470	3"
*	3-1/2"
007-21490	4"
*	5"
*	6"
*	8"
*	10"
*	12"
*	14"
*	16"
*	18"
*	20"
*	24"

*NON STOCK CALL JABO SUPPLY

OTHER SIZES AVAIL UPON REQUEST

MTR AVAILABLE

**BLIND
RAISED FACE****DOMESTIC**

JABO PART#	SIZE
*	1/2"
007-22460	3/4"
007-22470	1"
*	1-1/4"
007-22490	1-1/2"
007-22500	2"
*	2-1/2"
007-22520	3"
*	3-1/2"
007-22540	4"
*	5"
007-22550	6"
*	8"
*	10"
*	12"
*	14"
*	16"
*	18"
*	20"
*	24"

*NON STOCK CALL JABO SUPPLY

OTHER SIZES AVAIL UPON REQUEST

MTR AVAILABLE

**WELD NECK
RAISED STD BORE****DOMESTIC**

JABO PART#	SIZE
007-20100	3"
007-20140	4"
007-20160	6"
007-20180	8"
ALL OTHER SIZE NON STOCK	



CLASS 150 FLANGE BOLT PATTERN AND LENGTH

PROVIDED BY WELDBEND CATALOG

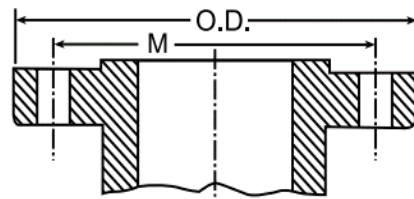

Flange

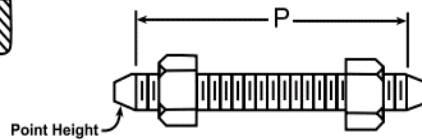

Stud Bolt

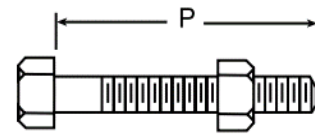

Machine Bolt

PLEASE LET YOUR CSR KNOW
WHEN ORDERING IF AN MTR IS

Bolting Pattern and Bolt Lengths								
Pipe Size	Outside Diameter	Drilling				Length of Bolts		
		Diameter of Bolt Circle	Diameter of Bolt Holes	Number of Bolt Holes	Diameter of Bolts	Stud Bolts Raised Face 0.06 in.	Stud Bolts Ring Joint	Machine Bolts Raised Face 0.06 in.
	O.D.	M				P	P	P

ASME B16.5

1/2	3.50	2.38	5/8	4	1/2	2.25	*	2.00
3/4	3.88	2.75	5/8	4	1/2	2.50	*	2.00
1	4.25	3.12	5/8	4	1/2	2.50	3.00	2.25
1 1/4	4.62	3.50	5/8	4	1/2	2.75	3.25	2.25
1 1/2	5.00	3.88	5/8	4	1/2	2.75	3.25	2.50
2	6.00	4.75	3/4	4	5/8	3.25	3.75	2.75
2 1/2	7.00	5.50	3/4	4	5/8	3.50	4.00	3.00
3	7.50	6.00	3/4	4	5/8	3.50	4.00	3.00
3 1/2	8.50	7.00	3/4	8	5/8	3.50	4.00	3.00
4	9.00	7.50	3/4	8	5/8	3.50	4.00	3.00
5	10.00	8.50	7/8	8	3/4	3.75	4.25	3.25
6	11.00	9.50	7/8	8	3/4	4.00	4.50	3.25
8	13.50	11.75	7/8	8	3/4	4.25	4.75	3.50
10	16.00	14.25	1	12	7/8	4.50	5.00	4.00
12	19.00	17.00	1	12	7/8	4.75	5.25	4.00
14	21.00	18.75	1 1/8	12	1	5.25	5.75	4.50
16	23.50	21.25	1 1/8	16	1	5.25	5.75	4.50
18	25.00	22.75	1 1/4	16	1 1/8	5.75	6.25	5.00
20	27.50	25.00	1 1/4	20	1 1/8	6.25	6.75	5.50
24	32.00	29.50	1 3/8	20	1 1/4	6.75	7.25	6.00

CLASS 150 FLANGE DIMENSIONS

PROVIDED BY WELDBEND CATALOG

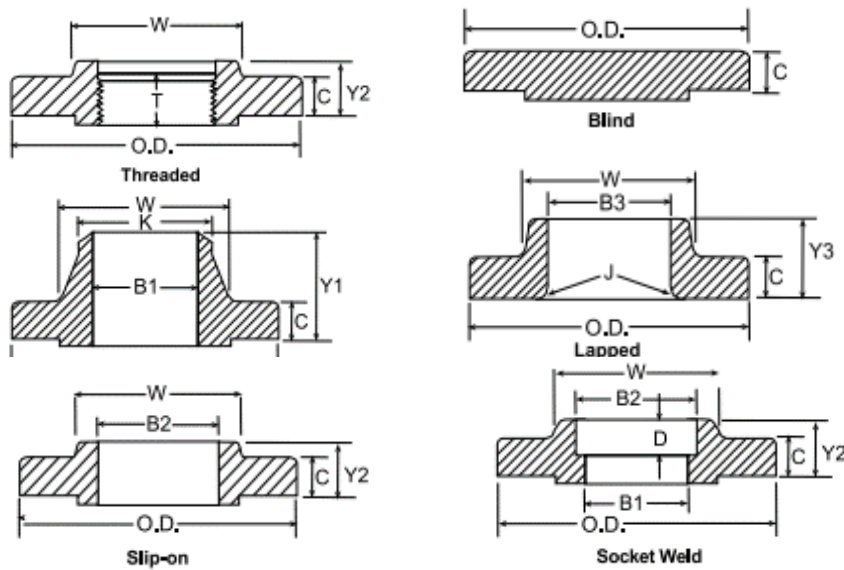

Pipe Size	Outside Diameter of Flange	Thickness of Flange (Min.)	Thickness of Lap Joint (Min.)	Diameter of Hub*	Diameter of Weld Neck	Length Through Hub			Thread Length (Min.)	Bore			Lap Joint Radius	Depth of Socket
						Threaded, Slip-on & Socket Weld (Min.)	Lap Joint	Weld Neck		Slip-on & Socket Weld (Min.)	Lap Joint (Min.)	Weld Neck & Socket Weld (Min.)		
ASME B16.5														
½	3.50	0.38	0.44	1.19	0.84	0.56	0.62	1.81	0.62	0.88	0.90	0.62	0.12	0.38
¾	3.88	0.44	0.50	1.50	1.05	0.56	0.62	2.00	0.62	1.09	1.11	0.82	0.12	0.44
1	4.25	0.50	0.56	1.94	1.32	0.62	0.69	2.12	0.69	1.36	1.38	1.05	0.12	0.50
1 ¼	4.62	0.56	0.62	2.31	1.66	0.75	0.81	2.19	0.81	1.70	1.72	1.38	0.19	0.56
1 ½	5.00	0.62	0.69	2.56	1.90	0.81	0.88	2.38	0.88	1.95	1.97	1.61	0.25	0.62
2	6.00	0.69	0.75	3.06	2.38	0.94	1.00	2.44	1.00	2.44	2.46	2.07	0.31	0.69
2 ½	7.00	0.81	0.88	3.56	2.88	1.06	1.12	2.69	1.12	2.94	2.97	2.47	0.31	0.75
3	7.50	0.88	0.94	4.25	3.50	1.12	1.19	2.69	1.19	3.57	3.60	3.07	0.38	0.81
3 ½	8.50	0.88	0.94	4.81	4.00	1.19	1.25	2.75	1.25	4.07	4.10	3.55	0.38	0.50
4	9.00	0.88	0.94	5.31	4.50	1.25	1.31	2.94	1.31	4.57	4.60	4.03	0.44	
5	10.00	0.88	0.94	6.44	5.56	1.38	1.44	3.44	1.44	5.66	5.69	5.05	0.44	
6	11.00	0.94	1.00	7.56	6.63	1.50	1.56	3.44	1.56	6.72	6.75	6.07	0.50	
8	13.50	1.06	1.12	9.69	8.63	1.69	1.75	3.94	1.75	8.72	8.75	7.98	0.50	
10	16.00	1.12	1.19	12.00	10.75	1.88	1.94	3.94	1.94	10.88	10.92	10.02	0.50	
12	19.00	1.19	1.25	14.38	12.75	2.12	2.19	4.44	2.19	12.88	12.92	12.00	0.50	
14	21.00	1.31	1.38	15.75	14.00	2.19	3.12	4.94	2.25	14.14	14.18	13.25	0.50	
16	23.50	1.38	1.44	18.00	16.00	2.44	3.44	4.94	2.50	16.16	16.19	15.25	0.50	
18	25.00	1.50	1.56	19.88	18.00	2.62	3.81	5.44	2.69	18.18	18.20	17.25	0.50	
20	27.50	1.62	1.69	22.00	20.00	2.81	4.06	5.62	2.88	20.20	20.25	19.25	0.50	
24	32.00	1.81	1.88	26.12	24.00	3.19	4.38	5.94	3.25	24.25	24.25	23.25	0.50	

CLASS 150 FLANGE WEIGHTS

PROVIDED BY WELDBEND CATALOG

CLASS 150					
Pipe Size	Outside Diameter	Threaded & Slip-on	Weld Neck	Blind	Lap Joint
	O.D.				
ASME B16.5					
½	3.50	2.00	2.00	2.00	1.00
¾	3.88	2.00	2.00	2.00	2.00
1	4.25	2.00	3.00	2.00	2.00
1 ¼	4.62	3.00	3.00	3.00	3.00
1 ½	5.00	3.00	4.00	4.00	3.00
2	6.00	5.00	6.00	5.00	5.00
2 ½	7.00	8.00	10.00	7.00	8.00
3	7.50	9.00	11.50	9.00	9.00
3 ½	8.50	12.00	12.00	13.00	11.00
4	9.00	13.00	16.50	17.00	13.00
5	10.00	15.00	21.00	20.00	15.00
6	11.00	19.00	26.00	27.00	19.00
8	13.50	30.00	42.00	47.00	30.00
10	16.00	43.00	54.00	70.00	43.00
12	19.00	64.00	88.00	123.00	64.00
14	21.00	90.00	114.00	140.00	105.00
16	23.50	106.00	140.00	180.00	140.00
18	25.00	130.00	165.00	220.00	160.00
20	27.50	165.00	197.00	285.00	195.00
24	32.00	220.00	268.00	430.00	275.00

CLASS 300 FLANGE BOLT PATTERN AND LENGTH

PROVIDED BY WELDBEND CATALOG

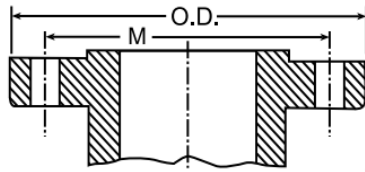

Flange

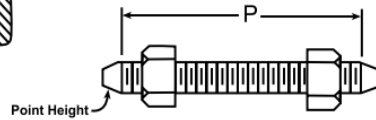

Stud Bolt

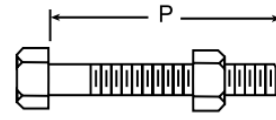

Machine Bolt

Bolting Pattern and Bolt Lengths								
Pipe Size	Outside Diameter	Drilling				Length of Bolts		
		Diameter of Bolt Circle	Diameter of Bolt Holes	Number of Bolt Holes	Diameter of Bolts	Stud Bolts Raised Face 0.06 in.	Stud Bolts Ring Joint	Machine Bolts Raised Face 0.06 in.
	O.D.	M				P	P	P

ASME B16.5

1/2	3.75	2.62	5/8	4	1/2	2.50	3.00	2.25
3/4	4.62	3.25	3/4	4	5/8	3.00	3.50	2.50
1	4.88	3.50	3/4	4	5/8	3.00	3.50	2.50
1 1/4	5.25	3.88	3/4	4	5/8	3.25	3.75	2.75
1 1/2	6.12	4.50	7/8	4	3/4	3.50	4.00	3.00
2	6.50	5.00	3/4	8	5/8	3.50	4.00	3.00
2 1/2	7.50	5.88	7/8	8	3/4	4.00	4.50	3.25
3	8.25	6.62	7/8	8	3/4	4.25	4.75	3.50
3 1/2	9.00	7.25	7/8	8	3/4	4.25	5.00	3.75
4	10.00	7.88	7/8	8	3/4	4.50	5.00	3.75
5	11.00	9.25	7/8	8	3/4	4.75	5.25	4.25
6	12.50	10.62	7/8	12	3/4	4.75	5.50	4.25
8	15.00	13.00	1	12	7/8	5.50	6.00	4.75
10	17.50	15.25	1 1/8	16	1	6.25	6.75	5.50
12	20.50	17.75	1 1/4	16	1 1/8	6.75	7.25	5.75
14	23.00	20.25	1 1/4	20	1 1/8	7.00	7.50	6.25
16	25.50	22.50	1 3/8	20	1 1/4	7.50	8.00	6.50
18	28.00	24.75	1 3/8	24	1 1/4	7.75	8.25	6.75
20	30.50	27.00	1 3/8	24	1 1/4	8.00	8.75	7.25
24	36.00	32.00	1 5/8	24	1 1/2	9.00	10.00	8.00

CLASS 300 FLANGE DIMENSIONS

PROVIDED BY WELDBEND CATALOG

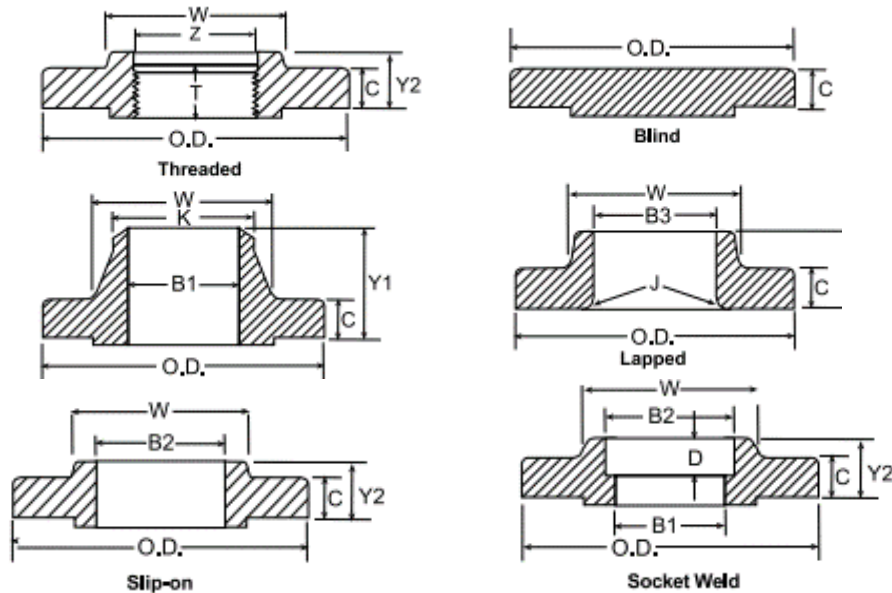

Pipe Size	Outside Diameter of Flange	Thickness of Flange (Min.)	Thickness of Lap Joint (Min.)	Diameter of Hub*	Diameter of Weld Neck	Length Through Hub			Thread Length (Min.)	Bore			Lap Joint Radius	Min. Counter Bore Threaded Flange	Depth of Socket
						Threaded, Slip-on & Socket Weld	Lap Joint	Weld Neck		Slip-on & Socket Weld (Min.)	Lap Joint (Min.)	Weld Neck & Socket Weld			
	O.D.	C	C	W	K	Y2	Y3	Y1	T	B2	B3	B1 ▲	J	Z	D

ASME B16.5

½	3.75	0.50	0.56	1.50	0.84	0.81	0.88	2.00	0.62	0.88	0.90	0.62	0.12	0.93	0.38
¾	4.62	0.56	0.62	1.88	1.05	0.94	1.00	2.19	0.62	1.09	1.11	0.82	0.12	1.14	0.44
1	4.88	0.62	0.69	2.12	1.32	1.00	1.06	2.38	0.69	1.36	1.38	1.05	0.12	1.41	0.50
1 ¼	5.25	0.69	0.75	2.50	1.66	1.00	1.06	2.50	0.81	1.70	1.72	1.38	0.19	1.75	0.56
1 ½	6.12	0.75	0.81	2.75	1.90	1.13	1.19	2.63	0.88	1.95	1.97	1.61	0.25	1.98	0.62
2	6.50	0.81	0.88	3.31	2.38	1.25	1.31	2.69	1.12	2.44	2.46	2.07	0.31	2.50	0.69
2 ½	7.50	0.94	1.00	3.94	2.88	1.44	1.50	2.94	1.25	2.94	2.97	2.47	0.31	3.00	0.75
3	8.25	1.06	1.12	4.62	3.50	1.63	1.69	3.06	1.25	3.57	3.60	3.07	0.38	3.63	0.81
3 ½	9.00	1.12	1.19	5.25	4.00	1.69	1.75	3.13	1.44	4.07	4.10	3.55	0.38	4.13	
4	10.00	1.19	1.25	5.75	4.50	1.82	1.88	3.32	1.44	4.57	4.60	4.03	0.44	4.63	
5	11.00	1.31	1.38	7.00	5.56	1.94	2.00	3.82	1.69	5.66	5.69	5.05	0.44	5.69	
6	12.50	1.38	1.44	8.12	6.63	2.00	2.06	3.82	1.81	6.72	6.75	6.07	0.50	6.75	
8	15.00	1.56	1.62	10.25	8.63	2.38	2.44	4.32	2.00	8.72	8.75	7.98	0.50	8.75	
10	17.50	1.81	1.88	12.62	10.75	2.56	3.75	4.56	2.19	10.88	10.92	10.02	0.50	10.88	
12	20.50	1.94	2.00	14.75	12.75	2.82	4.00	5.06	2.38	12.88	12.92	12.00	0.50	12.94	
14	23.00	2.06	2.12	16.75	14.00	2.94	4.38	5.56	2.50	14.14	14.18	13.25	0.50	14.19	
16	25.50	2.19	2.25	19.00	16.00	3.19	4.75	5.69	2.69	16.16	16.19	15.25	0.50	16.19	
18	28.00	2.31	2.38	21.00	18.00	3.44	5.12	6.19	2.75	18.18	18.20	17.25	0.50	18.19	
20	30.50	2.44	2.50	23.12	20.00	3.69	5.50	6.32	2.88	20.20	20.25	19.25	0.50	20.19	
24	36.00	2.69	2.75	27.62	24.00	4.13	6.00	6.56	3.25	24.25	24.25	23.25	0.50	24.19	

CLASS 300 FLANGE WEIGHTS

PROVIDED BY WELD BEND CATALOG

CLASS 300					
Pipe Size	Outside Diameter	Threaded & Slip-on	Weld Neck	Blind	Lap Joint
	O.D.				

ASME B16.5

½	3.75	3.00	2.00	2.00	2.00
¾	4.62	3.00	3.00	3.00	3.00
1	4.88	3.00	4.00	4.00	3.00
1 ¼	5.25	4.50	5.00	6.00	4.50
1 ½	6.12	6.50	7.00	7.00	6.50
2	6.50	7.00	9.00	8.00	7.00
2 ½	7.50	10.00	12.00	12.00	10.00
3	8.25	14.00	18.00	16.00	14.00
3 ½	9.00	17.00	20.00	21.00	17.00
4	10.00	24.00	26.50	28.00	24.00
5	11.00	31.00	36.00	37.00	28.00
6	12.50	39.00	45.00	50.00	39.00
8	15.00	58.00	69.00	81.00	58.00
10	17.50	81.00	100.00	124.00	91.00
12	20.50	115.00	142.00	185.00	140.00
14	23.00	165.00	206.00	250.00	190.00
16	25.50	220.00	250.00	315.00	234.00
18	28.00	280.00	320.00	415.00	305.00
20	30.50	325.00	400.00	515.00	375.00
24	36.00	490.00	580.00	800.00	550.00

CLASS 600 FLANGE BOLT PATTERN & LENGTH

PROVIDED BY WELDBEND CATALOG

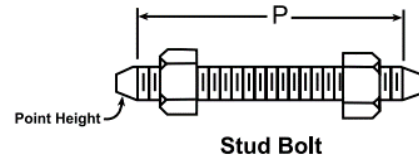
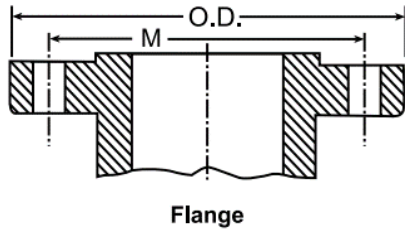

Bolting Pattern and Bolt Lengths								
Pipe Size	Outside Diameter	Drilling				Length of Bolts		
		Diameter of Bolt Circle	Diameter of Bolt Holes	Number of Bolt Holes	Diameter of Bolts	Raised Face 0.25 in.	Male & Female / Tongue & Groove	Ring Joint
	O.D.	M				P	P	P

ASME B16.5

1/2	3.75	2.62	5/8	4	1/2	3.00	2.75	3.00
3/4	4.62	3.25	3/4	4	5/8	3.50	3.25	3.50
1	4.88	3.50	3/4	4	5/8	3.50	3.25	3.50
1 1/4	5.25	3.88	3/4	4	5/8	3.75	3.50	3.75
1 1/2	6.12	4.50	7/8	4	3/4	4.25	4.00	4.25
2	6.50	5.00	3/4	8	5/8	4.25	4.00	4.25
2 1/2	7.50	5.88	7/8	8	3/4	4.75	4.50	4.75
3	8.25	6.62	7/8	8	3/4	5.00	4.75	5.00
3 1/2	9.00	7.25	1	8	7/8	5.50	5.25	5.50
4	10.75	8.50	1	8	7/8	5.75	5.50	5.75
5	13.00	10.50	1 1/8	8	1	6.50	6.25	6.50
6	14.00	11.50	1 1/8	12	1	6.75	6.50	6.75
8	16.50	13.75	1 1/4	12	1 1/8	7.50	7.25	7.75
10	20.00	17.00	1 3/8	16	1 1/4	8.50	8.25	8.50
12	22.00	19.25	1 3/8	20	1 1/4	8.75	8.50	8.75
14	23.75	20.75	1 1/2	20	1 3/8	9.25	9.00	9.25
16	27.00	23.75	1 5/8	20	1 1/2	10.00	9.75	10.00
18	29.25	25.75	1 3/4	20	1 5/8	10.75	10.50	10.75
20	32.00	28.50	1 3/4	24	1 5/8	11.25	11.00	11.50
24	37.00	33.00	2	24	1 7/8	13.00	12.75	13.25

CLASS 600 FLANGE DIMENSIONS

PROVIDED BY WELDBEND CATALOG

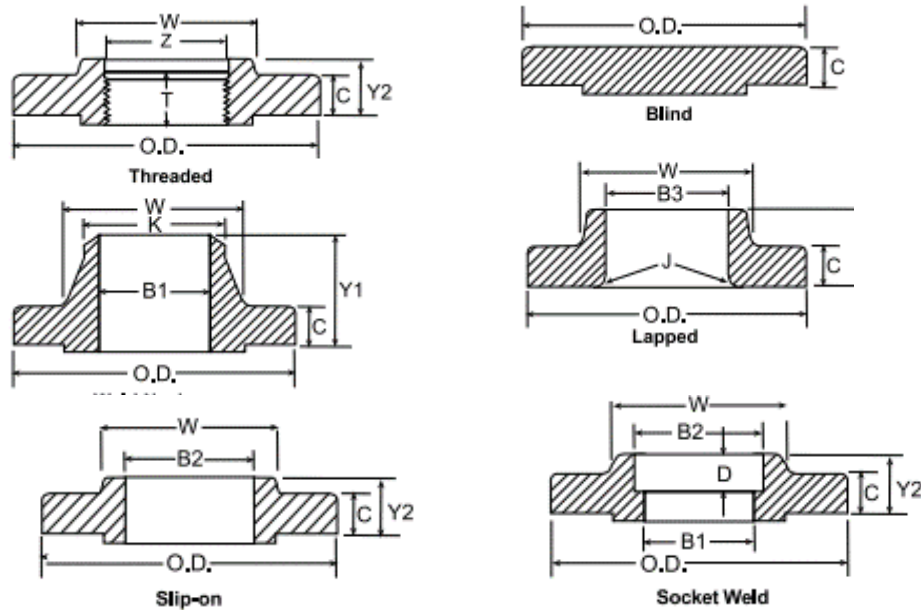

Pipe Size	Outside Diameter of Flange	Thickness of Flange (Min.)	Diameter of Hub*	Diameter of Weld Neck	Length Through Hub			Thread Length (Min.)	Bore			Lapped Flange Radius	Min. Counter Bore Threaded Flange	Depth of Socket
					Threaded, Slip-on & Socket Weld	Lap Joint	Weld Neck		Slip-on & Socket Weld (Min.)	Lap Joint (Min.)	Weld Neck & Socket Weld			
	O.D.	C	W	K	Y2	Y3	Y1	T	B2	B3	B1 ▲	J	Z	D

ASME B16.5

½	3.75	0.56	1.50	0.84	0.88	0.88	2.06	0.62	0.88	0.90	.55	0.12	0.93	0.38
¾	4.62	0.62	1.88	1.05	1.00	1.00	2.25	0.62	1.09	1.11	.74	0.12	1.14	0.44
1	4.88	0.69	2.12	1.32	1.06	1.06	2.44	0.69	1.36	1.38	.96	0.12	1.41	0.50
1 ¼	5.25	0.81	2.50	1.66	1.12	1.12	2.62	0.81	1.70	1.72	1.28	0.19	1.75	0.56
1 ½	6.12	0.88	2.75	1.90	1.25	1.25	2.75	0.88	1.95	1.97	1.50	0.25	1.99	0.62
2	6.50	1.00	3.31	2.38	1.44	1.44	2.88	1.12	2.44	2.46	1.94	0.31	2.50	0.69
2 ½	7.50	1.12	3.94	2.88	1.62	1.62	3.12	1.25	2.94	2.97	2.32	0.31	3.00	0.75
3	8.25	1.25	4.62	3.50	1.81	1.81	3.25	1.38	3.57	3.60	2.90	0.38	3.63	0.81
3 ½	9.00	1.38	5.25	4.00	1.94	1.94	3.38	1.56	4.07	4.10	3.36	0.38	4.13	
4	10.75	1.50	6.00	4.50	2.12	2.12	4.00	1.62	4.57	4.60	3.83	0.44	4.63	
5	13.00	1.75	7.44	5.56	2.38	2.38	4.50	1.88	5.66	5.69	4.81	0.44	5.69	
6	14.00	1.88	8.75	6.63	2.62	2.62	4.62	2.00	6.72	6.75	5.76	0.50	6.75	
8	16.50	2.19	10.75	8.63	3.00	3.00	5.25	2.25	8.72	8.75	7.63	0.50	8.75	
10	20.00	2.50	13.50	10.75	3.38	4.38	6.00	2.56	10.88	10.92	9.75	0.50	10.88	
12	22.00	2.62	15.75	12.75	3.62	4.62	6.12	2.75	12.88	12.92	11.75	0.50	12.94	
14	23.75	2.75	17.00	14.00	3.69	5.00	6.50	2.88	14.14	14.18	13.00	0.50	14.19	
16	27.00	3.00	19.50	16.00	4.19	5.50	7.00	3.06	16.16	16.19	15.00	0.50	16.19	
18	29.25	3.25	21.50	18.00	4.62	6.00	7.25	3.12	18.18	18.20	17.00	0.50	18.19	
20	32.00	3.50	24.00	20.00	5.00	6.50	7.50	3.25	20.20	20.25	19.00	0.50	20.19	
24	37.00	4.00	28.25	24.00	5.50	7.25	8.00	3.62	24.25	24.25	23.00	0.50	24.19	

CLASS 600 FLANGE WEIGHTS

PROVIDED BY WELDBEND CATALOG

CLASS 600					
Pipe Size	Outside Diameter	Threaded & Slip-on	Weld Neck	Blind	Lap Joint
	O.D.				
ASME B16.5					
½	3.75	2.00	3.00	3.00	2.00
¾	4.62	3.00	4.00	4.00	3.00
1	4.88	4.00	4.00	4.00	4.00
1 ¼	5.25	5.00	6.00	6.00	5.00
1 ½	6.12	7.00	8.00	8.00	7.00
2	6.50	9.00	12.00	10.00	9.00
2 ½	7.50	13.00	18.00	15.00	12.00
3	8.25	16.00	23.00	20.00	15.00
3 ½	9.00	21.00	26.00	29.00	20.00
4	10.75	37.00	42.00	41.00	36.00
5	13.00	63.00	68.00	68.00	63.00
6	14.00	80.00	81.00	86.00	78.00
8	16.50	115.00	120.00	140.00	112.00
10	20.00	177.00	190.00	231.00	195.00
12	22.00	215.00	226.00	295.00	240.00
14	23.75	259.00	347.00	378.00	290.00
16	27.00	366.00	481.00	527.00	400.00
18	29.25	476.00	555.00	665.00	469.00
20	32.00	612.00	690.00	855.00	604.00
24	37.00	876.00	977.00	1250.00	866.00

CARBON STEEL FLANGES



JABO SUPPLY SINCE 1964 SERVICE IS MORE THAN A PROMISE
(304)-736-8333