



# JABO SUPPLY



# HYDRANTS

# PREFIXES



## 5 LOCATIONS

**PARKERSBURG, WV**  
 10085 Emerson Avenue 26102  
 (304) 464-4400

**NORTON, VA**  
 205 Hawthorne Drive, 24273  
 (276) 679-1224

**HUNTINGTON, WV**  
 209 Braley Street, 25705  
 (304) 736-8333

**MORGANFIELD, KY**  
 118 Jim Veatch Road, 42437  
 (270) 389-3430

**BEAVER, WV (BECKLEY)**  
 227 C&O Shop Road 25813  
 (304-252-0000

SINCE 1964 SERVICE IS MORE THAN A PROMISE





## PREFIXES

**INDEX**

DESCRIPTIONS	PAGE #
<b>PICTURE INDEX</b>	<b>4</b>
<b>27N NOSTAL COMPONENT LIST</b>	<b>5</b>
<b>AWWA C502 DRY BARRELL OPTIONS</b>	<b>6-7</b>
<b>STOCK HYDRANTS non AIS</b>	<b>8-9</b>
<i>*6" MJ Shoe</i>	<i>8</i>
<i>*6" MJ Shoe with Storz</i>	<i>8</i>
<i>*6" With Hymax Shoe</i>	<i>9</i>
<b>AIS HYDRANTS</b>	<b>9</b>
<b>2780 NOSTALGIC HYDRANT EXPLODED PARTS BREAKDOWN</b>	<b>10-11</b>

# HYDRANT PICTURE INDEX

## HYDRANTS

HOW TO BUILD A NON STOCK	DRY BARRELL (STOCK)	DRY BARRELL (STOCK)	DRY BARRELL (STOCK)
<p><b>BUILD YOUR HYDRANT BY USING PAGE 6-7</b></p>	<p><b>6" MJ SHOE</b></p>	<p><b>6" MJ SHOE WITH STORZ</b></p>	<p><b>6" HYMAX SHOE 5" STORZ</b></p>
<p><b>Pages 6-7</b></p>			
<p><b>WET BARRELL</b></p>			
<p><b>NON STOCK</b></p>			
			
<p><b>CALL JABO SUPPLY</b></p>			

**AMERICAN AVK HIGH PRESSURE, 250 PSI, NOSTALGIC, DUAL 2 1/2" HOSE OUTLET, DRY BARREL HYDRANT**

**27N/NHH NOSTALGIC DUAL HOSE OUTLET**

Meets or exceeds AWWA C502 (latest) - Working Pressure - 250 PSI

Inlet Bases: Flanged in accordance with ANSI B16.1 Class 125,

Mechanical and Push-On Joint in accordance with ANSI/AWWA C111/A21.11

**Component List:**

- |                            |                            |                                  |  |
|----------------------------|----------------------------|----------------------------------|--|
| 1. Weathershield Bolt      | 15. Stem Seal O-rings      | 33. Breakable Flange             | 55. Brass Plug -Not shown              |
| 2. Weathershield           | 16. Upper Stem Rod         | 34. Nozzle Section Nut           | 56. Brass Fitting -Not shown           |
| 3. Lock Plate Screw        | 17. Barrel Gasket          | 36. Coupler Pin                  | 60. Main Valve Retaining Pin -Detail A |
| 4. Lock Plate              | 18. Bonnet Nut             | 37. Breakable Stem Rod Coupling  | 61. Main Valve Disc -Detail A          |
| 5. Inner Thrust Nut O-ring | 19. Hose Nozzle Cap        | 38. Spring Pin                   | 62. Base Gasket -Detail A              |
| 6. Thrust Nut              | 20. Hose Nozzle            | 41. Lower Stem Rod               | 64. Stud Bolt -Detail A                |
| 7. Outer Thrust Nut O-ring | 21. Hose Nozzle Cap Gasket | 44. Extension Boly -Detail A     | 67. Base                               |
| 8. Anti-Friction Washer    | 22. Hose Nozzle O-ring     | 46. Standpipe Flange -Detail A   | 75. Zerk Fitting                       |
| 9. Lubrication Hole Seal   | 23. Nozzle Retaining Screw | 49. Lower Barrel                 |  |
| 10. Operating Nut          | 24. Chain Set              | 50. Lower Barrel O-ring Detail A |  |
| 11. Stop Nut               | 29. Nozzle Section         | 51. Valve Seat Rng -Detail A     |  |
| 12. Bonnet Bolt            | 30. Nozzle Section Bolt    | 53. Valve Seat O-ring -Detail A  |  |
| 13. Bonnet Washer          | 31. Nozzle Section Washer  | 54. Drain Ring -Detail A         |  |
| 14. Bonnet                 | 32. Lock Ring              |                                  |  |

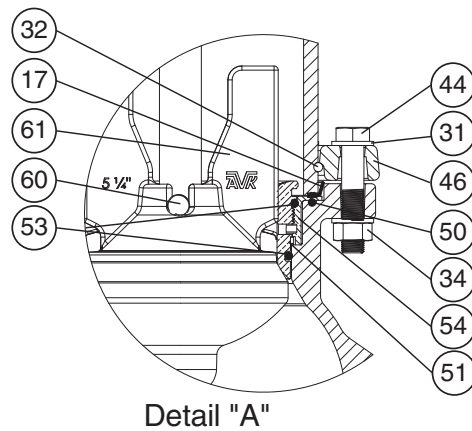
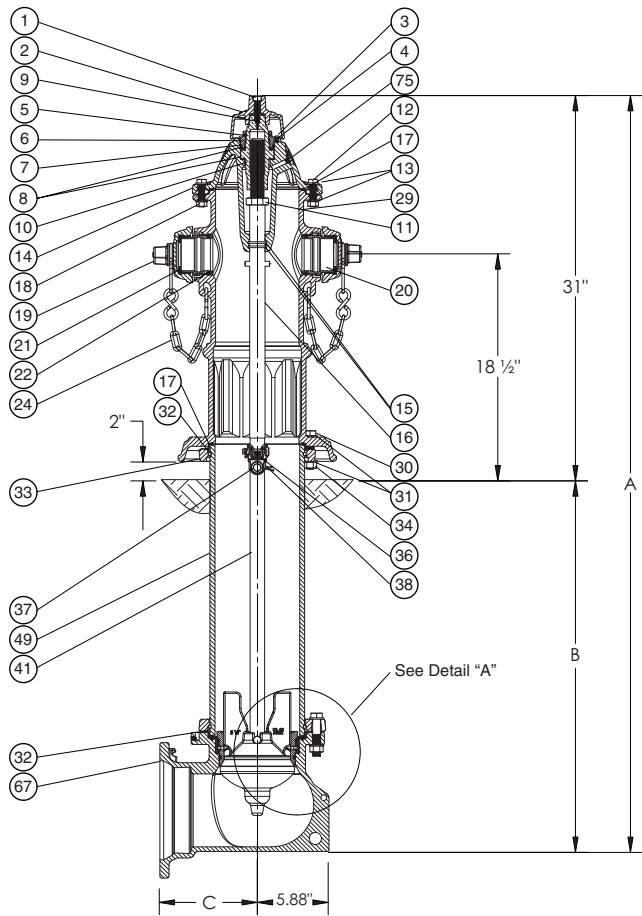

Ref No.	Base Sizes	Outlets	A	B*	C				
					Flanged	MJ	Push-on	PE	HYMAX GRIP®
27N-NHH-4	- 4"	2x2 1/2"	49" - 247"	18" - 216"	8.00"	8.00"	N/A	23.70"	N/A
27N-NHH-6	- 6"	2x2 1/2"	49" - 247"	18" - 216"	8.00"	8.00"	9.00"	22.80"	11.60"
27N-NHH-8	- 8"	2x2 1/2"	49" - 247"	18" - 216"	N/A	9.38"	N/A	N/A	N/A

\* Buries greater than 216" available upon request.



DS S27N/NHH NOSTALGIC DUAL HOSE OUTLET  
Subject to change without notice. (rev. 09/20)

AWWA DRY BARRELL OPTIONS

AWWA C502, DRY BARREL

# HYDRANT – OPTIONS

**AWWA C502 DRY BARREL HYDRANT OPTIONS**

• Style

- 27M – Modern (2700)
- 27N – Nostalgic (2780)

• Pumper/Outlet Options

- NHH– No Pumper (N), 2 Hose (H)
- PHH– 1 Pumper (P), 2 Hose (H)
- PNN– 1 Pumper (P), No Hose (N)
- PPN– 2 Pumper (P), No Hose (N)

• Pumper Nozzle

- Size 3.5" 4" 4.5" 5"
- Thread Type \_\_\_\_\_

• Hose Nozzle

- Thread type \_\_\_\_\_

• Chains

- With Chains
- Without Chains

• Operating Nut

- Size \_\_\_\_\_
- Shape Hexagon Pentagon Square Triangle

• Upper Barrel – 27M Modern only

- Standard 12"
- 16" - ( Overall height )
- 18" ( 6" - Extended )
- 22" - ( Overall height )
- 30" (Alpine)
- Monitor Elbow – 3" flange  4" flange

• Lower Barrel

- Bitumen
- Non-bitumen
- PUR – ( PUR coating below ground )

• Bolting Above Ground

- Zinc Plated Steel ( Standard )
- 304 Stainless Steel
- 316 Stainless

• Bolting Below Ground

- 304 Stainless Steel ( Standard )
- 316 Stainless Steel
- Zinc Plated Steel

• Opening Direction

- Open Left
- Open Right

• Main Valve

- Hydro Flow - Standard

• Drain Facility

- Plugged seat ring
- Plugged main valve flange – Base
- Drains unplugged

• Upper Stem

- 304 Stainless ( Standard )
- 316 Stainless
- C63000 Bronze
- Steel with brass sleeve

• Lower Stem

- Standard steel ( Standard )
- 304 Stainless
- 316 Stainless
- C63000 Bronze

• Stem Coupler

- Standard
- Charleston Type
- Vancouver Type

• Lubrication

- Grease Filled
- Oil Filled

• PE Inlet Configuration

- Size 4"  6"
- PE Type, IPS  DIPS
- PE Wall Thickness DR 9  DR11  DR13.5

• Other Inlet Configurations

- Size 4"  6"  8"
- Type FL  MJ  PO  Straight

• Bury Depth, Lower Barrel – Hydrant no.

- Depth in feet \_\_\_\_\_

• Lower Barrel Extension

- Length in 6" increments \_\_\_\_\_

AWWA C502, DRY BARREL HYDRANTS

AWWA DRY BARRELL OPTIONS

AWWA C502, DRY BARREL

HYDRANT – OPTIONS (cont.)

AWWA C502 DRY BARREL HYDRANT OPTIONS (CONT.)

- Lower Barrel Extension Canadian ( Halton ) Type
- Length in 6" increments \_\_\_\_\_

- Bearings
- Delrin ( Standard )
- Roller ( Torrington type )

- Color
- Body \_\_\_\_\_
- Hose Cap \_\_\_\_\_
- Pumper Cap \_\_\_\_\_
- Bonnet \_\_\_\_\_
- Weathershield \_\_\_\_\_
- \*Special Color \_\_\_\_\_

\*Special Colors may require price adders.  
Please contact your territory representative.\*

- FlowGuard I™ ( Optional )
- 316 Bolting
- PUR Coating

- Security
- None ( Standard )
- Tamper Proof Weathershield
- Tamper Proof Thrust Nut

- Stem Nut / Weathershield
- Size 1.5" Pent.  1" Square
- Weathershield type \_\_\_\_\_

- Special Options – All special options must be approved by AVK

• \_\_\_\_\_

AWWA C502 DRY BARREL HYDRANT OPTIONS

Customer: \_\_\_\_\_

Municipality: \_\_\_\_\_

Engineer: \_\_\_\_\_

Requested By: \_\_\_\_\_

Date: \_\_\_\_\_

Approval Name: \_\_\_\_\_

Signature: \_\_\_\_\_

Title: \_\_\_\_\_

AWWA C502 DRY BARREL HYDRANT ACRONYMS :

- AWWA - American Water Works Association**
- DIPS - Ductile Iron Pipe Size**
- EPDM - Ethylene Propylene Diene Monomer**
- FL - Flange**
- FM - Factory Mutual**
- GR - Grooved**
- HDPE - High Density Polyethylene**
- IPS - Iron Pipe Size**

- MJ - Mechanical Joint**
- PE - Polyethylene**
- PO - Push - On**
- PUR - Polyurethane**
- SDR - Standard Dimension Ratio**
- SS - Stainless Steel**
- UL - Underwriters Laboratories**

AWWA C502, DRY BARREL HYDRANTS

# STOCK HYDRANTS

## HYDRANTS

NON AIS

### 6" MJ SHOES

#### DRY BARREL HYDRANT

STD 6" X MJ SHOE		
NON AIS		
		
JABO PART#	BURY	MFG #
135-29995	3'	27N/PHH-04
135-30000	3-1/2'	27N/PHH-05
135-30004	4'	27N/PHH-06
135-30006	4-1/2'	27N/PHH-07

Style	27N-NOSTALGIC
Pumper Outlet Options	PPH-1Pumper (P), 2 Hose (H)
STORZ Connection	NO
Drain Facility	Drains Unplugged
Opening Direction	Opens Left
Lubrication	Grease Filled
Size Inlet	6"
Type of Inlet	MJ
Bury Depth (Total Depth)	See Bury Depth
Pumper Nozzle Size	4.5"
Pumper Nozzle Threads	NST
Hose Nozzle Size	2.5"
Hose Nozzle Threads	NST
Operating Nut Size	1.5"
Operating Nut Shape	Pentagon
Chains	Yes
Color	Red

### 6" MJ SHOE WITH STORZ CONNECTION

#### DRY BARREL HYDRANT

5" STORZ		
NON AIS		
		
JABO PART#	BURY	MFG #
*	3'	
*	3-1/2'	
135-30008	4'	27UPO2906-0CM0B-1
*	4-1/2'	

Style	27N-NOSTALGIC
Pumper Outlet Options	PPH-1Pumper (P), 2 Hose (H)
STORZ CONNECTION	YES 5"
Drain Facility	Drains Unplugged
Opening Direction	Opens Left
Lubrication	Grease Filled
Size Inlet	6"
Type of Inlet	MJ
Bury Depth (Total Depth)	See Bury Depth
Pumper Nozzle Size	4.5"
Pumper Nozzle Threads	NST
Hose Nozzle Size	2.5"
Hose Nozzle Threads	NST
Operating Nut Size	1.5"
Operating Nut Shape	Pentagon
Chains	Yes
Color	Red

**HYDRANTS**

NON AIS

**6" HYMAX SHOE**

**DRY BARREL HYDRANT**

6" HYMAX SHOE		
NON AIS		
		
JABO PART#	BURY	MFG #
*	3'	
135-30015	3-1/2'	27N-PHH-05-6HYMAX
135-30020	4'	27N-PHH-06-6HYMAX
*	4-1/2'	

Style	27N-NOSTALGIC
Pumper Outlet Options	PPH-1Pumper (P), 2 Hose (H)
STORZ	NO
Drain Facility	Drains Unplugged
Opening Direction	Opens Left
Lubrication	Grease Filled
Size Inlet	6"
Type of Inlet	HYMAX
Bury Depth (Total Depth)	See Bury Depth
Pumper Nozzle Size	4.5"
Pumper Nozzle Threads	NST
Hose Nozzle Size	2.5"
Hose Nozzle Threads	NST
Operating Nut Size	1.5"
Operating Nut Shape	Pentagon
Chains	Yes
Color	Red

**HYDRANTS**

AIS

AVK HYDRANTS are compliant with AIS (American Iron and Steel) & BABA (Build America Buy America) . However, these hydrants must be identified at the time of order to receive the necessary paper work. These valves are specific to each job. .

### American AVK Series 2780 Nostalgic Hydrant Exploded Parts Breakdown

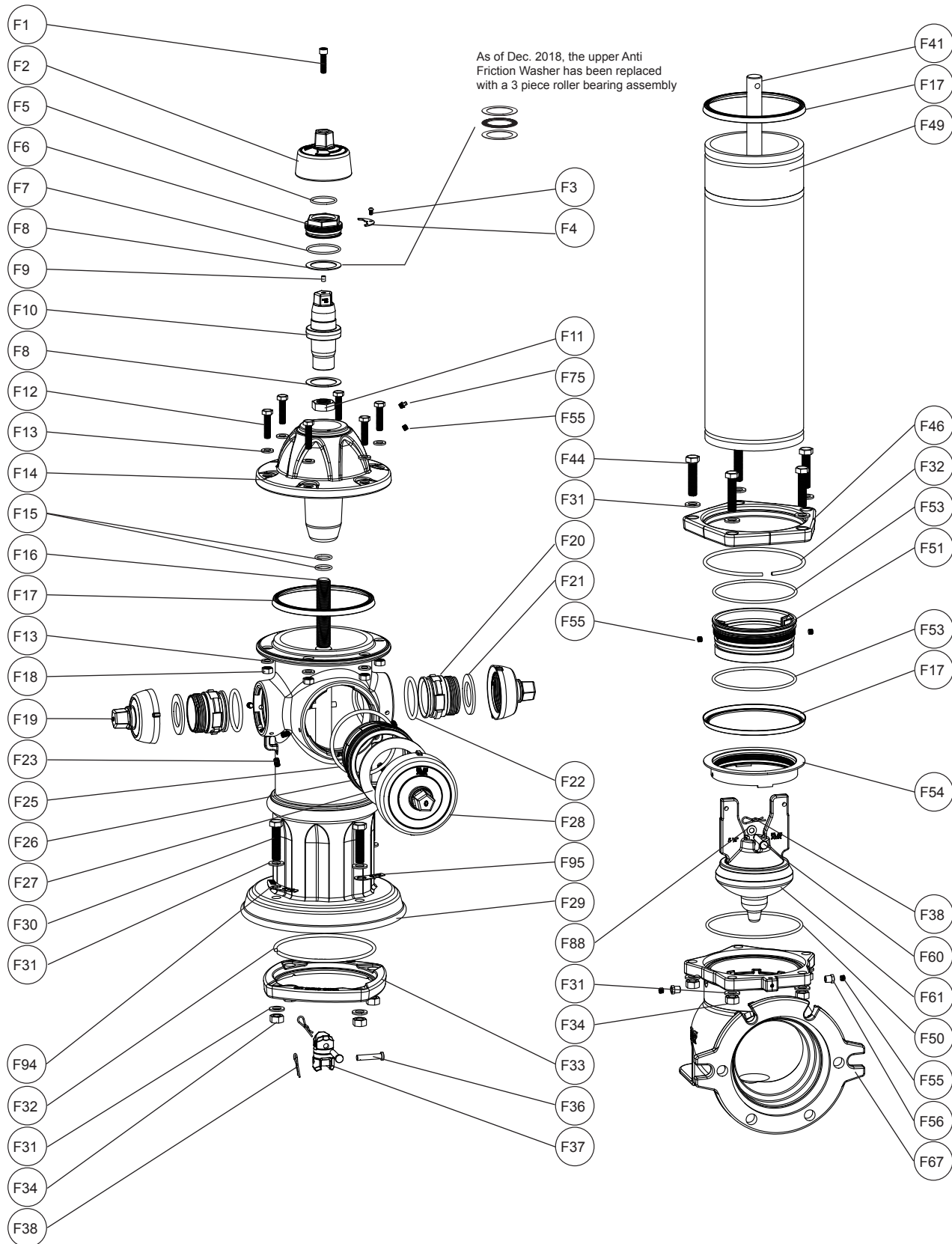

Item No.	Description	Material
F1	Weathershield Bolt	304 Stainless steel
F2	Weathershield	Grey Iron, ASTM126, Class "B"
F3	Lockplate Bolt	304 Stainless steel
F4	Lock Plate	304 Stainless steel
F5	Inner Thrust Nut O-ring	NBR
F6	Thrust Nut	Copper Alloy
F7	Outer Thrust Nut O-ring	NBR
F8	Anti Friction Washer	Nylon
F9	Lubrication Hole Seal	NBR
F10	Operating Nut	Copper Alloy
F11	Stop Nut	Zinc plated steel
F12	Bonnet Bolt	Zinc plate, 304, 316 Stainless steel
F13	Bonnet Washer	Zinc plate, 304, 316 Stainless steel
F14	Bonnet	Ductile Iron, ASTM A536
F15	Stem Seal O-rings	NBR
F16	Upper Stem Rod	304 Stainless steel, Epoxy coated steel
F17	Barrel Gasket	NBR with stainless steel insert
F18	Bonnet Nut	Zinc plate, 304, 316 Stainless steel
F19	Hose Nozzle Cap	Grey Iron, ASTM126, Class "B"
F20	Hose Nozzle	Copper Alloy
F21	Hose Nozzle Cap Gasket	NBR
F22	Hose Nozzle O-ring	NBR
F23**	Set Screw - (Nozzle)	304 Stainless steel
F24*	Chain Assembly	Zinc Plated Steel
F25	Pumper Nozzle O-ring	NBR
F26	Pumper Nozzle	Copper Alloy
F27	Pumper Cap Gasket	NBR
F28	Pumper Cap	Grey Iron, ASTM126, Class "B"
F29	Nozzle Section	Ductile Iron, ASTM A536
F30	Nozzle Section Bolt	Zinc plate, 304, 316 Stainless steel
F31	Nozzle Section Washer	304 Stainless steel
F32	Lock Ring	304 Stainless steel
F33	Breakable Flange	Ductile Iron, ASTM A536
F34	Nozzle Section Nut	304 Stainless steel
F35*	Upper Barrel	Ductile Iron, ASTM A536
F36	Coupler Pin	420 Stainless steel
F37	Breakable Stem Rod Coupling	431 Stainless steel
F38	Spring Pin	304 Stainless steel
F41	Lower Stem Rod	Mild Steel, 304 Stainless steel
F42*	Extension Coupling	304 Stainless steel
F43*	Extension Barrel	Ductile Iron, ASTM A536
F44	Upper.Extension Barrel Bolt	Zinc plate, 304, 316 Stainless steel
F45	N/A	
F46	Standpipe Flange	Ductile Iron, ASTM A536
F47*	Monitor Elbow	Ductile Iron, ASTM A536
F48*	Extension Stem Rod	Mild Steel, 304 Stainless steel
F49	Lower Barrel	Ductile Iron, ASTM A536
F50	Lower Barrel O-ring	NBR
F51	Valve Seat Ring	Copper Alloy
F52	N/A	
F53	Valve Seat O-ring	NBR
F54	Drain Ring	Copper Alloy
F55	Brass Plug	Copper Alloy
F56	Brass Fitting	Copper Alloy
F58	N/A	
F60	Main Valve Retaining Pin	420 Stainless steel
F61	Main Valve	EPDM, Encapsulated Ductile Iron
F62	Base Gasket	NBR
F63*	Straight Inlet	Ductile Iron, ASTM A536
F65	N/A	
F66	N/A	
F67	Base	Ductile Iron, ASTM A536
F68	N/A	
F69***	Thrust Bearing Race	Hardened Steel
F70***	Thrust Bearing	Hardened Steel
F71*	Modern Nozzle Section Bolt	Zinc plate, 304, 316 Stainless steel
F72*	Base Gasket - Specify type	NBR
F73*	Storz Cap O-ring	EPDM
F74*	Cap/Cable Assembly	
F75	Zerk Fitting	Case Hardened Steel, Zinc Plated
F88	Main Valve Retaining Pin Washer	304 Stainless steel
F90*	Hose Nozzle Position Clip	300 Series Stainless
F91*	Pumper Nozzle Position Clip	300 Series Stainless
F92*	Inner Storz Cap O-ring	NBR
F93*	Storz Adaptor	Copper Alloy
F94	Bury Tag	Aluminum
F95	Extension Bury Tag	Aluminum

\* Not Shown in Exploded Parts Breakdown

\*\* As of July 2015, secondary Set Screws were added to all dry barrel nozzle outlets

\*\*\* As of Dec. 2018, the upper Anti Friction Washer has been replaced with a 3 piece roller bearing assembly comprised of 2, F69 Thrust Bearing Races and 1, F70 Thrust Bearing.



# JABO SUPPLY

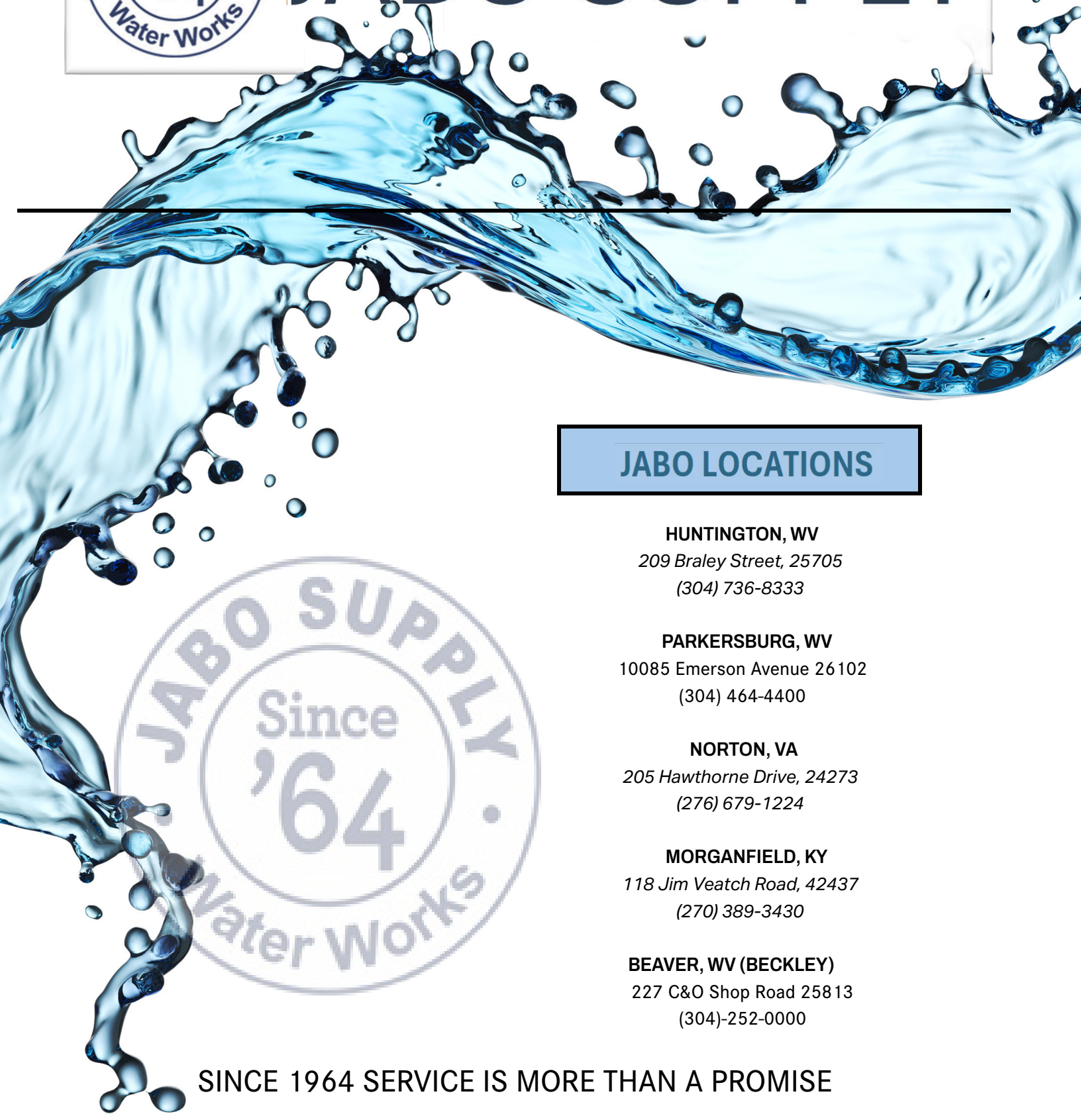

## JABO LOCATIONS

### **HUNTINGTON, WV**

209 Braley Street, 25705  
(304) 736-8333

### **PARKERSBURG, WV**

10085 Emerson Avenue 26102  
(304) 464-4400

### **NORTON, VA**

205 Hawthorne Drive, 24273  
(276) 679-1224

### **MORGANFIELD, KY**

118 Jim Veatch Road, 42437  
(270) 389-3430

### **BEAVER, WV (BECKLEY)**

227 C&O Shop Road 25813  
(304)-252-0000

**SINCE 1964 SERVICE IS MORE THAN A PROMISE**